

2001

Nuova Bianchi S.p.A spare parts serie restyling *ANTARES*

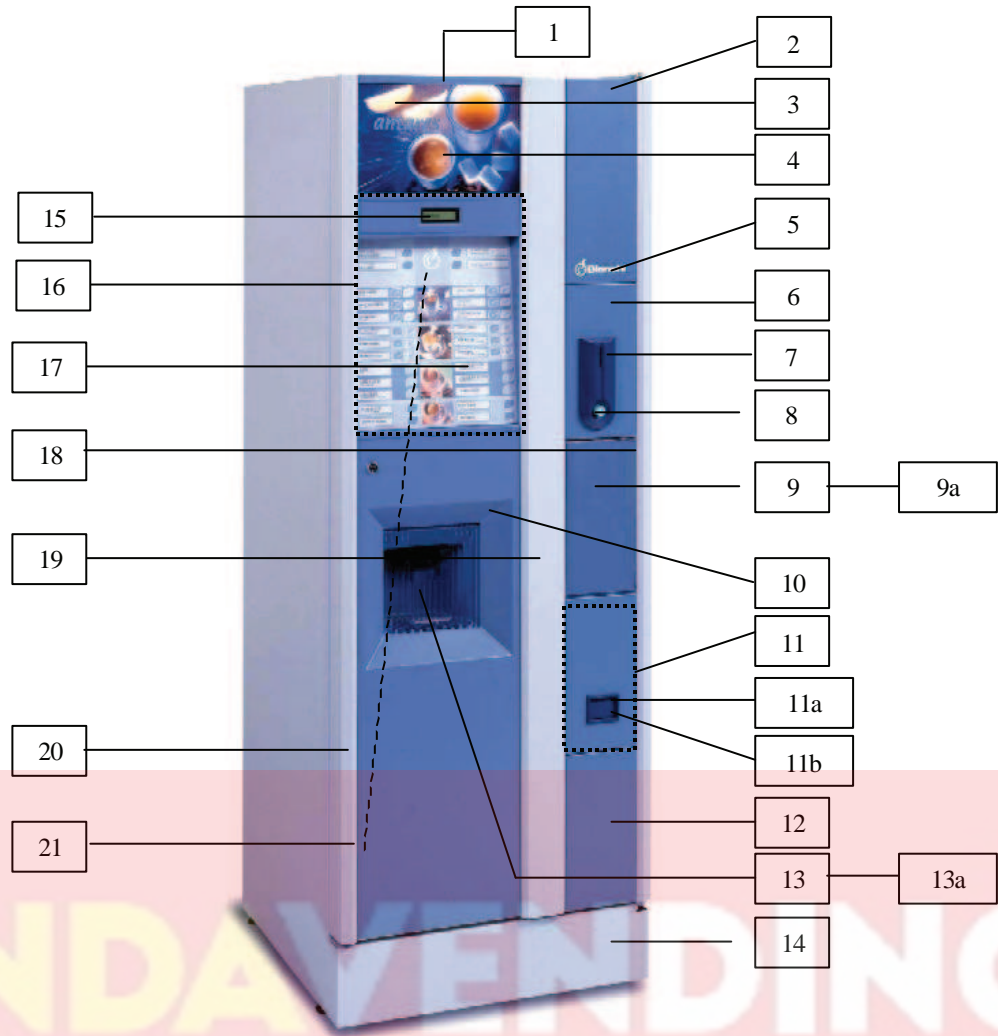

POSITION	CODE	DESCRIPTION	ITL PRICE
1	01448012L28	Upper panel bracket assembly	12.000
2	01530311L28	Upper module	10.600
3	05122811	Transparent panel	10.800
4	30081511	Front name panel	5.250
5	30074511	Nuova Bianchi decals	2.400
6	01530211L28	Coin introduction panel	11.600
7	05104515	Coin slot tab	3.150
8	05104445	Coin recovery button	900
9	05105811	Transparent panel	12.900
9a	30069231	Bleu pasteboard	650
10	05110845	Dispensing opening frame	28.450
11	01443612L28	Coin recovery panel assembly	15.300
11a	05018265	Coin recovery mask	4.150
11b	05083135	Coin recovery door	1.100
12	01453011L28	Lower module	8.900
13	05103255	Cup dispensing	12.800
13a	05103615	Transparent chamber door	8.350
14	01509111L10	Skirting board	18.800
15	26020012	Display	64.800
16	30073560	Keypad assembly	210.000
17	30081411	Keypad	126.000
18	01590811L10	Right bordering	24.000
19	01590911L10	Central bordering	30.780
20	01590711L10	Left bordering	24.000
21	30081911	Selection labels	10.800
	ANTARES BLUE	VARNISHED	

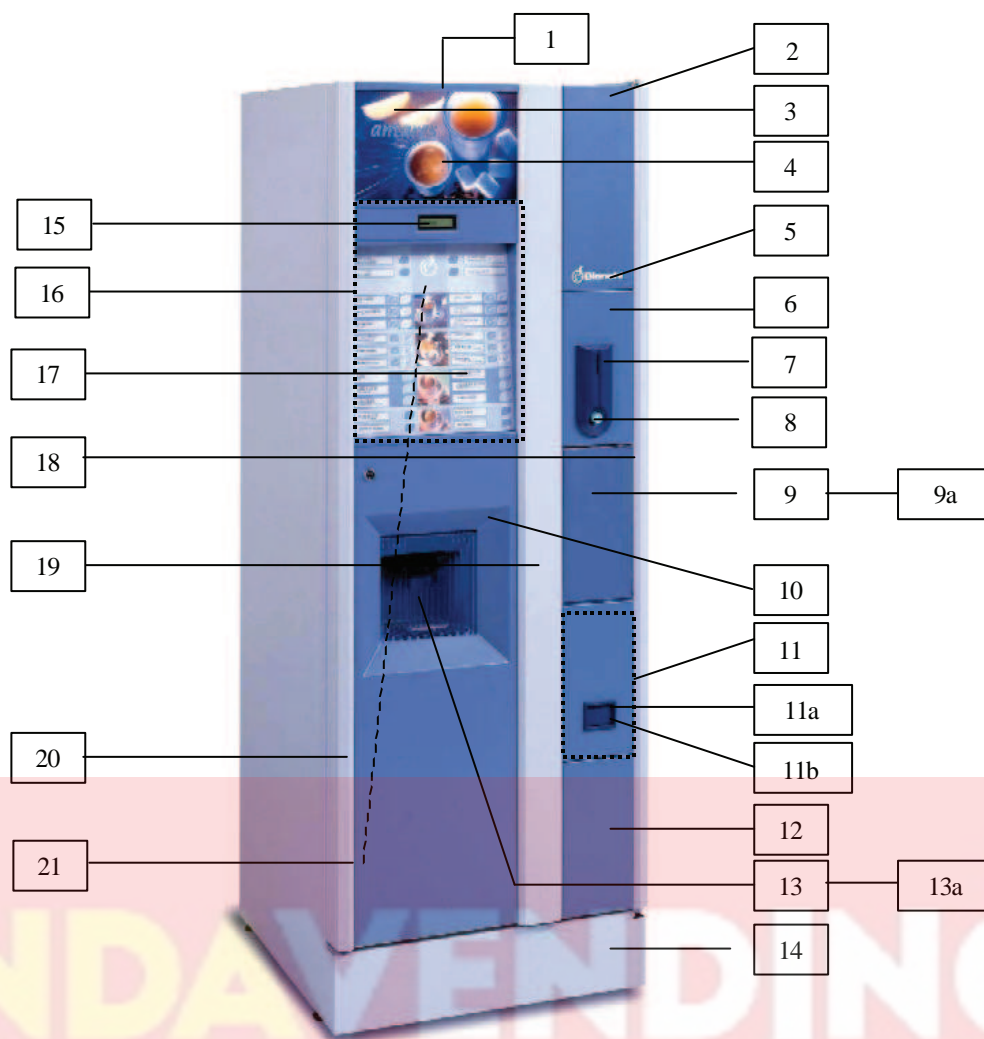

POSITION	CODE	DESCRIPTION	ITL PRICE
1	01448012L30	Upper panel bracket assembly	12.000
2	01530311L30	Upper module	10.600
3	05122811	Transparent panel	10.800
4	30081521	Front name panel	9.200
5	30074511	Nuova Bianchi decals	2.400
6	01530211L30	Coin introduction panel	11.600
7	05104565	Coin slot tab	3.150
8	05104435	Coin recovery button	800
9	05105811	Transparent panel	12.900
9a	30069241	Graphite gray pasteboard	1.100
10	05110855	Dispensing opening frame	28.450
11	01443612L30	Coin recovery panel assembly	15.300
11a	05018215	Coin recovery mask	4.150
11b	05083175	Coin recovery door	1.100
12	01453011L30	Lower module	8.900
13	05103225	Cup dispensing	14.000
13a	05103615	Transparent chamber door	8.350
14	01509111L30	Skirting board	18.800
15	26020012	Display	64.800
16	30073590	Keypad assembly	210.000
17	30081421	Keypad	172.800
18	01590121	Right bordering	24.000
19	01590221	Central bordering	30.780
20	01589821	Left bordering	24.000
21	30081921	Selection labels	10.800
<b>ANTARES</b>	<b>GRAPHITE GRAY</b>	<b>VARNISHED</b>	

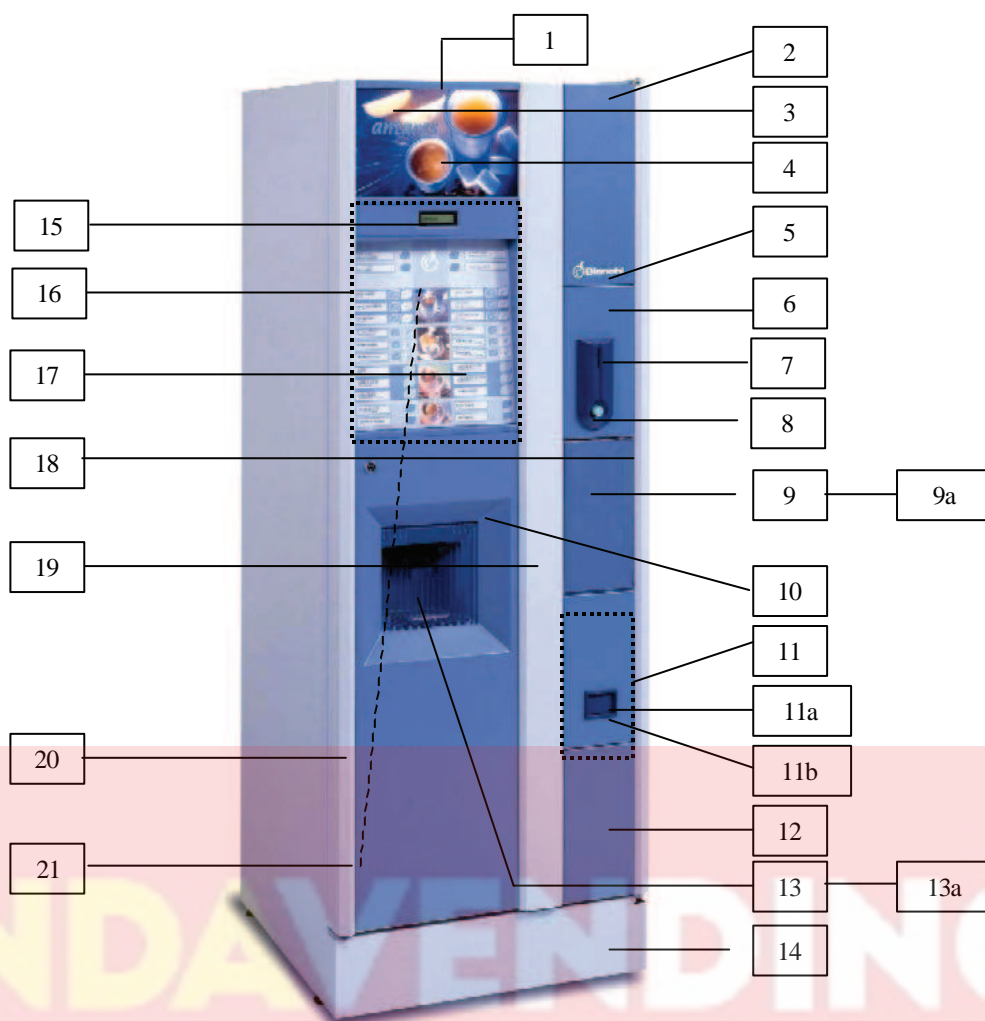

POSITION	CODE	DESCRIPTION	ITL PRICE
1	01448012L27	Upper panel bracket assembly	12.000
2	01530311L27	Upper module	10.600
3	05122811	Transparent panel	10.800
4	30081521	Front name panel	9.200
5	30074511	Nuova Bianchi decals	2.400
6	01530211L27	Coin introduction panel	11.600
7	05104565	Coin slot tab	3.150
8	05104435	Coin recovery button	800
9	05105811	Transparent panel	12.900
9a	30069241	Gaphite gray pasteboard	1.100
10	05110865	Dispensing opening frame	28.450
11	01443612L27	Coin recovery panel assembly	15.300
11a	05018215	Coin recovery mask	4.150
11b	05083175	Coin recovery door	1.100
12	01453011L27	Lower module	8.900
13	05103225	Cup dispensing	14.000
13a	05103615	Transparent chamber door	8.350
14	01509111L27	Skirting board	18.800
15	26020012	Display	64.800
16	30069140	Keypad assembly	210.000
17	30081421	Keypad	172.800
18	01590821	Right bordering	24.000
19	01590921	Central bordering	30.780
20	01590721	Left bordering	24.000
21	30081921	Selection labels	10.800
<b>ANTARES</b>	<b>SILVER GRAY</b>	<b>VARNISHED</b>	

**TIENDA VENDING** 



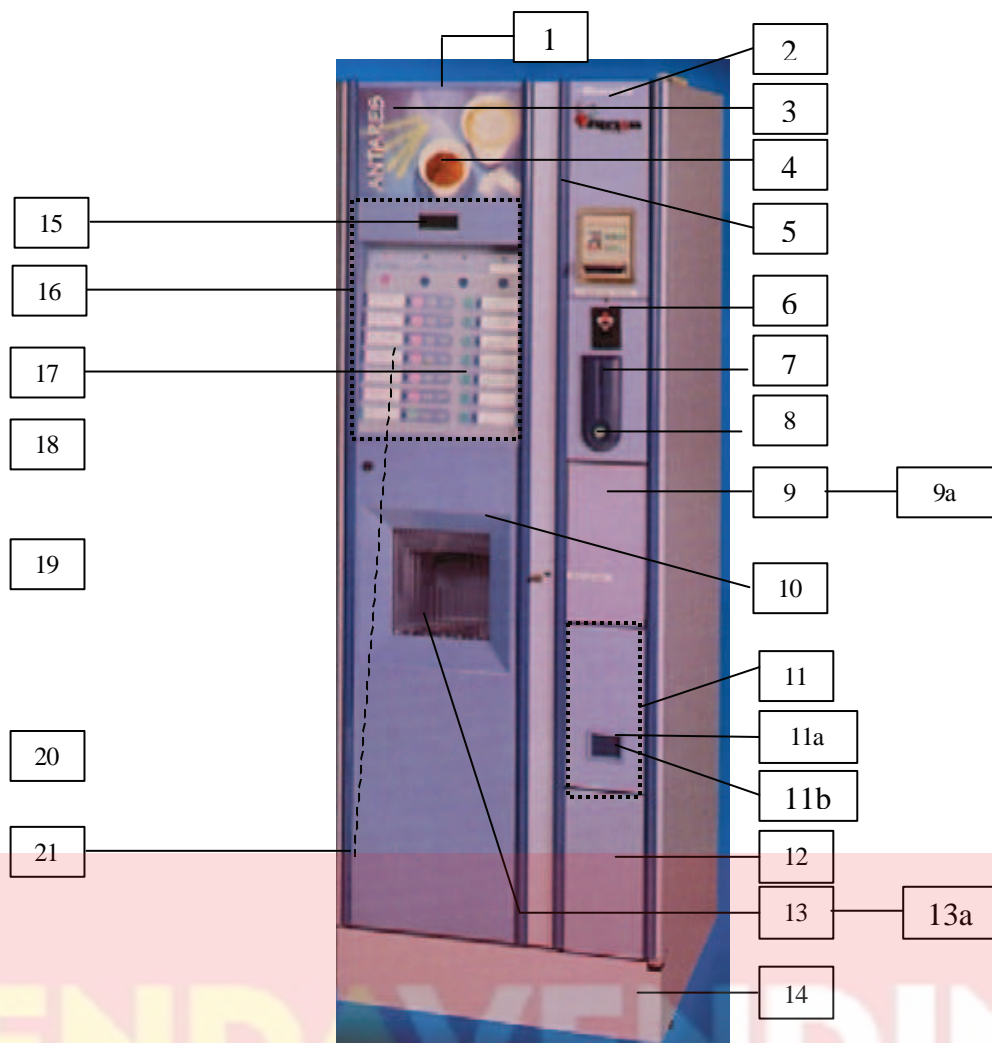

POSITION	CODE	DESCRIPTION	ITL PRICE
1	01448012L11	Upper panel bracket assembly	12.000
2	01530311L11	Upper module (soluble)	12.500
2a	05125511	Upper module (express)	12.500
3	05122811	Transparent panel	10.800
4	30073711	Front name panel	2.700
5	21012011L13	Bordering blue varnished	2.400
6	01530211L11	Coin introduction panel	11.500
7	05104515	Coin slot tab	3.150
8	05104415	Coin recovery button	1.200
9	05125611	Transparent panel	11.000
9a	30069211	Bleu pasteboard	350
10	0511845	Dispensing opening frame	29.000
11	01530012L11	Coin recovery panel assembly	12.000
11a	05018265	Coin recovery mask	4.150
11b	05083135	Coin recovery door	1.100
12	01453011L11	Lower module	11.000
13	05103255	Cup dispensing	12.800
13a	05103615	Transparent chamber door	8.350
14	01509111L10	Skirting board	18.800
15	26020012	Display	64.800
16	30073560	Keypad assembly	210.000
17	30081411	Keypad	126.000
18	#	Right bordering	#
19	#	Central bordering	#
20	#	Left bordering	#
21	30081911	Selection labels	10.800
	ANTARES BLUE	VARNISHED	

*Restyling models information and updates*

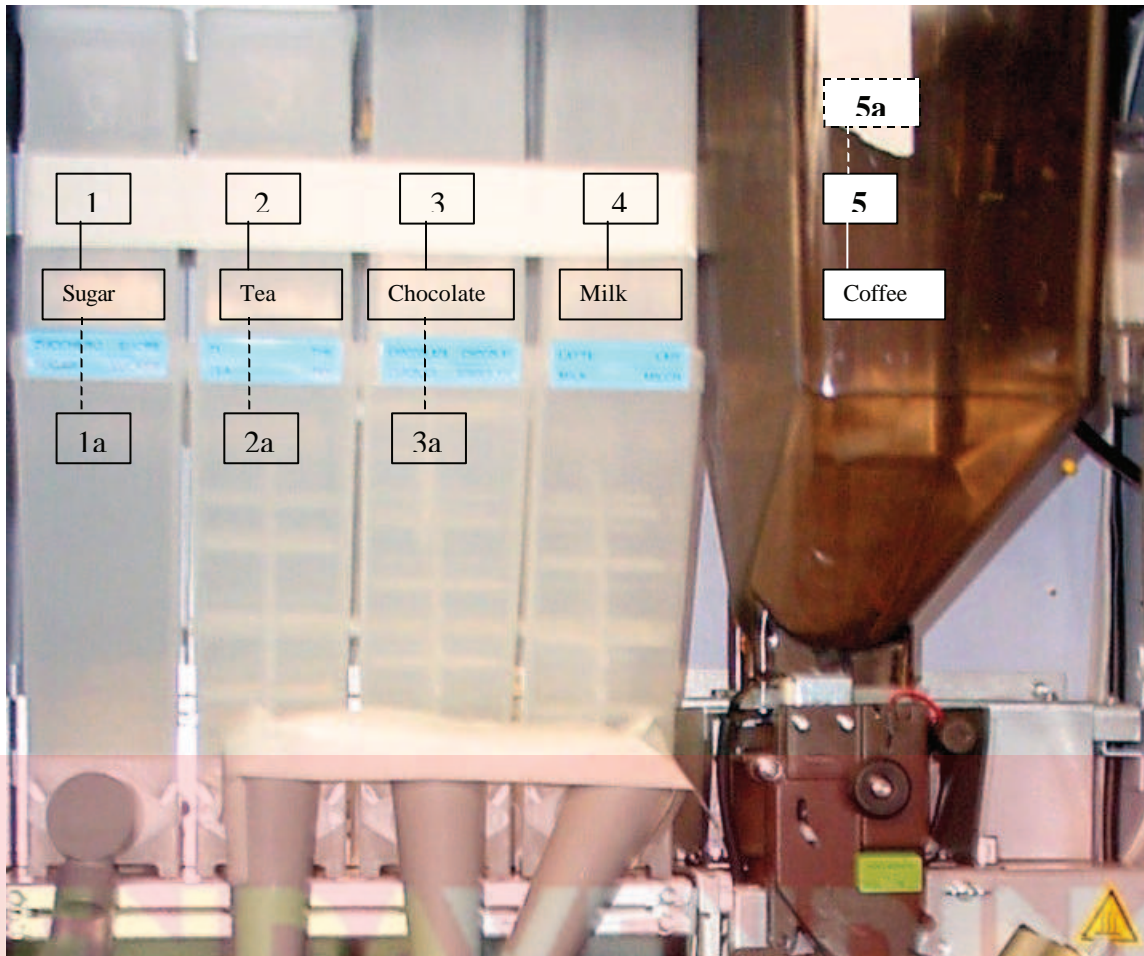

POSITION	CODE	DESCRIPTION	ITL PRICE
1	96035710 E	Low dosing canister	27.000
1a	96035810 E	Low dosing canister with wheel	27.800
2	96048610	Dosing canister with wheel (h 221)	35.000
2a	96035810 E	Low dosing canister with wheel	27.800
3	96048710	Dosing canister with two wheels (hight 221mm)	38.150
3a	96035910 E	Low dosing canister with two wheels	32.400
4	96048610	Dosing canister with wheel (h 221)	35.000
5	4831112049	Upper coffee hopper	28.200
5a	05095515	Coffee hopper cover	6.600

Restyling models information and updates

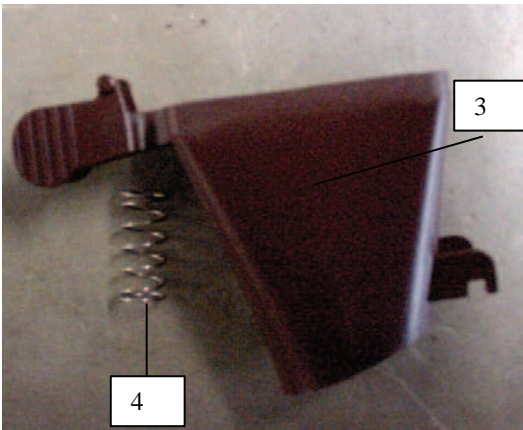

POSITION	CODE	DESCRIPTION	ITL PRICE
1	95007410	Express coffee group assembly	97.200

Attention the code 95004510-01\*\*\* for the models :  
 ANTARES in production to serial number 92532  
 PEGASO in production to serial number 92099  
 ORION/SIRIO in production to serial number 92532

\*\*\* NOT AVAILABLE OUT OF PRODUCTION  
 THE CURRENT CODE IS 95007410

POSITION	CODE	DESCRIPTION	ITL PRICE
2	96044410	Doser assembly	59.400

ANTARES beginning from to serial number 00087107  
 SIRIO/ORION beginning from to serial number 99064905

POSITION	CODE	DESCRIPTION	ITL PRICE
3	05135415	Coffee chute ***	2.350
4	07020911	Chute spring	200

\*\*\*

ANTARES beginning from to serial number 89680  
 ORION beginning from to serial number 89044  
 SIRIO mono boiler beginning from to serial number 90113  
 SIRIO double boiler beginning from to serial number 88987



*Restyling models information and updates*



POSITION	CODE	DESCRIPTION	ITL PRICE
1	95007410	Express coffe group assembly	82.500

Restyling models information and updates

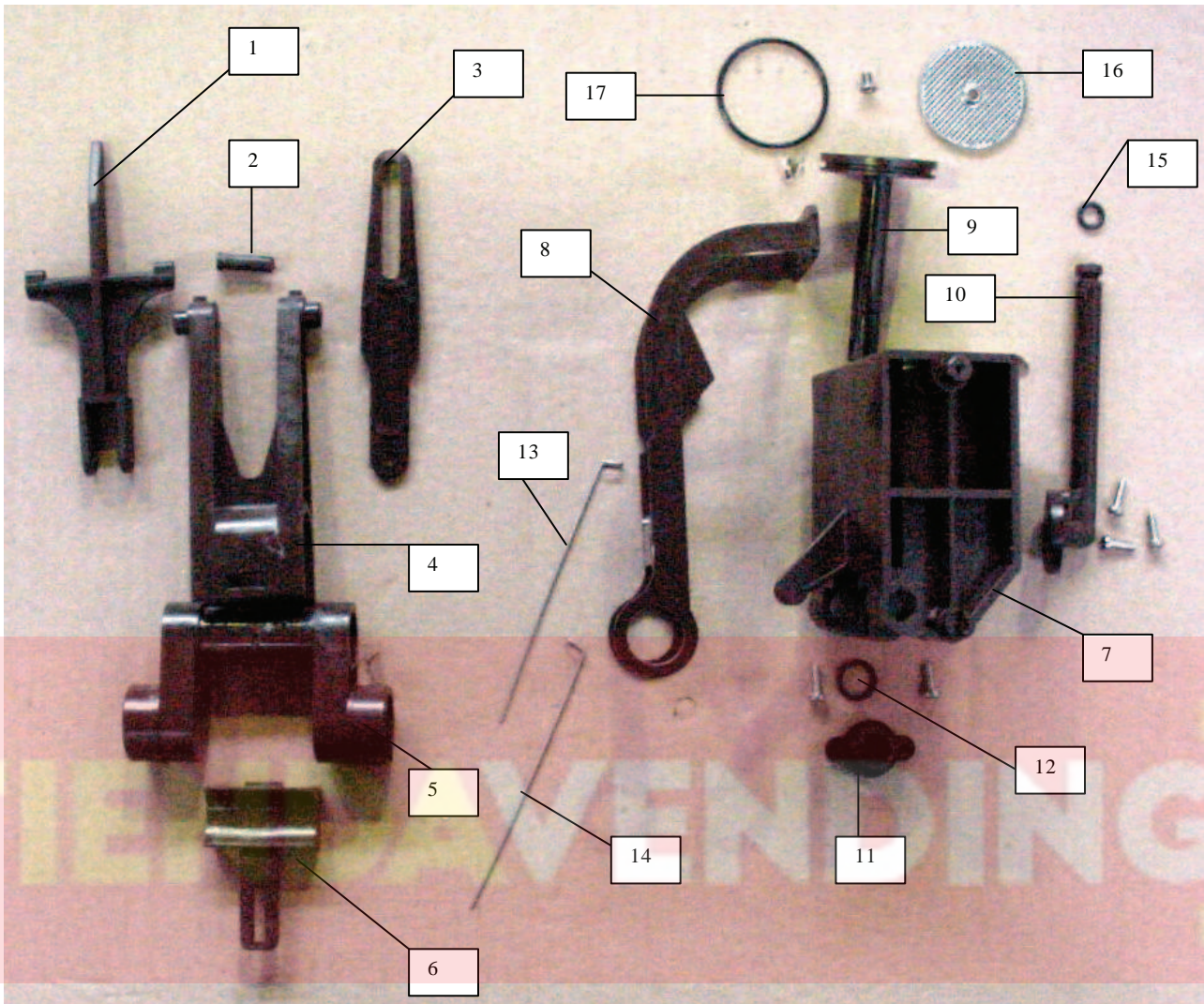

POSITION	CODE	DESCRIPTION	ITL PRICE
1	05148315	Rod filter	1.200
2	05107515	Rivet	930
3	05107415	Drive rod	1.800
4	05107115	Connecting rod	6.200
5	05107615	Crank	3.350
6	05107215	Stirrup	2.200
7	05106615-01	Cup	8.100
8	05107015	Spatula	6.300
9	05106915-01	Dreg ejector rod	7.300
10	05106815-01	Tube for cup	6.000
11	05106715	Cup bush	5.800
12	36211916	OR 2037 gasket	500
13	07017921	Left spatula spring	400
14	07017911	Right spatula spring	400
15	36210916	OR 2021 gasket	300
16	16012021	Coffe unit filter	3000
17	36212216	OR 2025 gasket	640





Restyling models information and updates

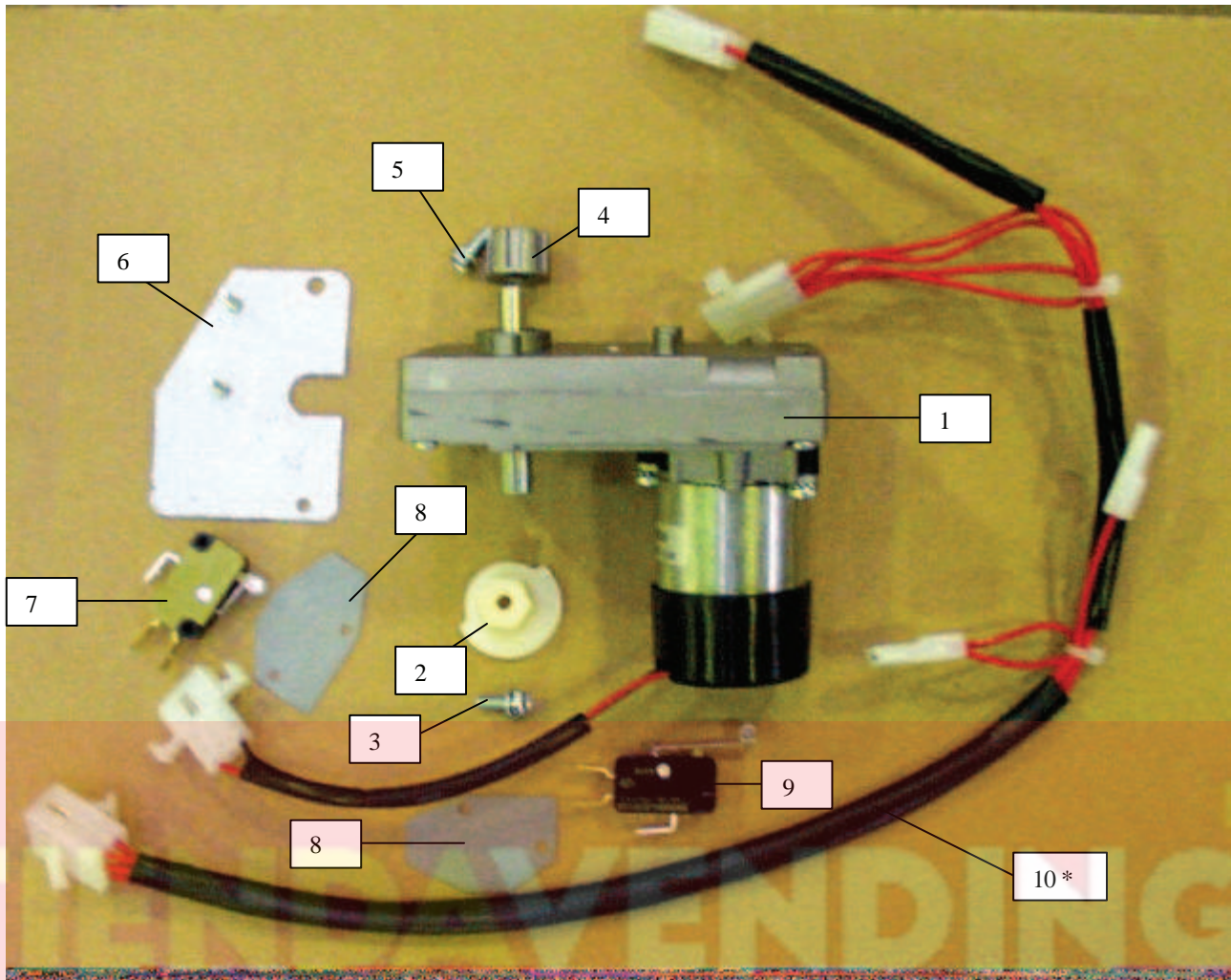

POSITION	CODE	DESCRIPTION	ITL PRICE
1	20014946-01	24 V D.C. gearmotor plastic group	87.000
2	05110915	Group rotation cam	1.350
3	32050516	TE M4x10 screw/Not available	#
4	19056616	Drive joint	1.800
5	32050516	TE M4x10 screw/Not available	#
6	01484212	Microswitch gearmotor plate assembly	2.520
7	26005126	XGM 2,81 S 20 micro with washer	6.250
8	08004111	Microswitch insulation	300
9	26005136	XGM 2,81 S 21 micro with washer	6.250
10	22117112	Low voltage cable ANTARES	9.000
10	22106712	Low voltage cable ORION	9.000
10	22106712	Low voltage cable SIRIO	9.000
10	22115612	Low voltage cable PEGASO	9.750



## Restyling models information and updates



1

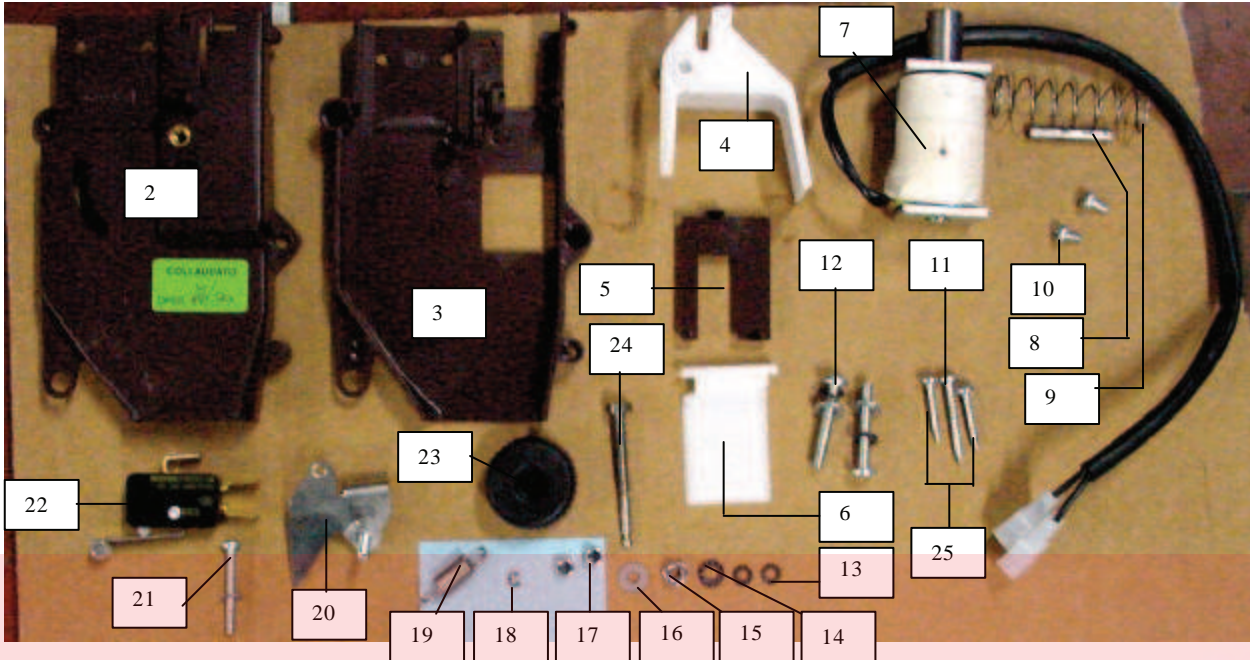

POSITION	CODE	DESCRIPTION	ITL PRICE
1	96044410	Doser assembly	59.400
2	05134815	Front cover	2.400
3	05134915	Rear cover	1.500
4	05135115	Pivoting coffee doser	700
5	05135015	Doser cover	400
6	05135315	Coffee lever	500
7	20019146	24 V D.C. 5% electricmagnet	22.500
8	33051716	Ø 4x25 doser shaft	650
9	07020511	Electricmagnet spring	2.550
10	32025216	TC 3X6 screw/Not available	#
11	32223316	2.9x25 self-screw/Not available	#
12	32061016	4x25 self-screw/Not available	#
13	35160316	Ø 3,2 washer/Not available	#
14	35160216	Ø 4,2 washer/Not available	#
15	34102816	M 4hexagonal nut/Not Available	#
16	35155136	Ø 3,2 washer/Not available	#
17	34110116	M 3hexagonal nut/Not Available	#
18	37000816	Ø 2.5-3 seger/Not available	#
19	07020611	Microswitch spring	3.250
20	01586212	Microswitch support	3.000
21	32026016	TC 3x25 screw/Not available	#
22	26005146	XGA ,81 S 21 microswitch	3.700
23	05135215	Knob	500
24	19058911	Adjustment screw	7.950
25	32223116	2,9x19 self-screw/Not available	#

*Restyling models information and updates*

**TIENDA VENDING**

*Restyling models information and updates*

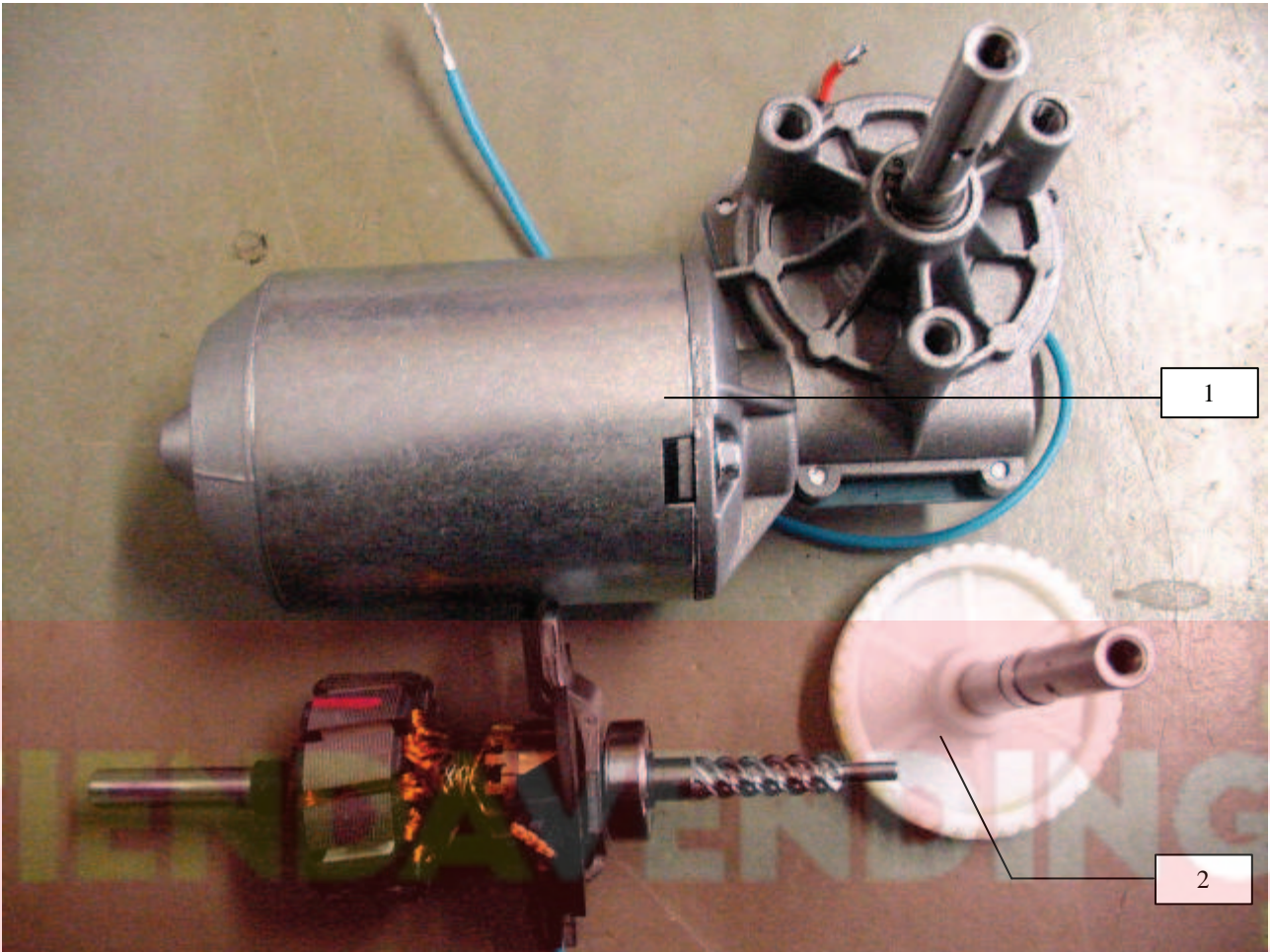

POSITION	CODE	DESCRIPTION	ITL PRICE
1	20019016	24 V D.C. grinder motor	97.200
2	41037716	Driving gear motor	



Restyling models information and updates

1

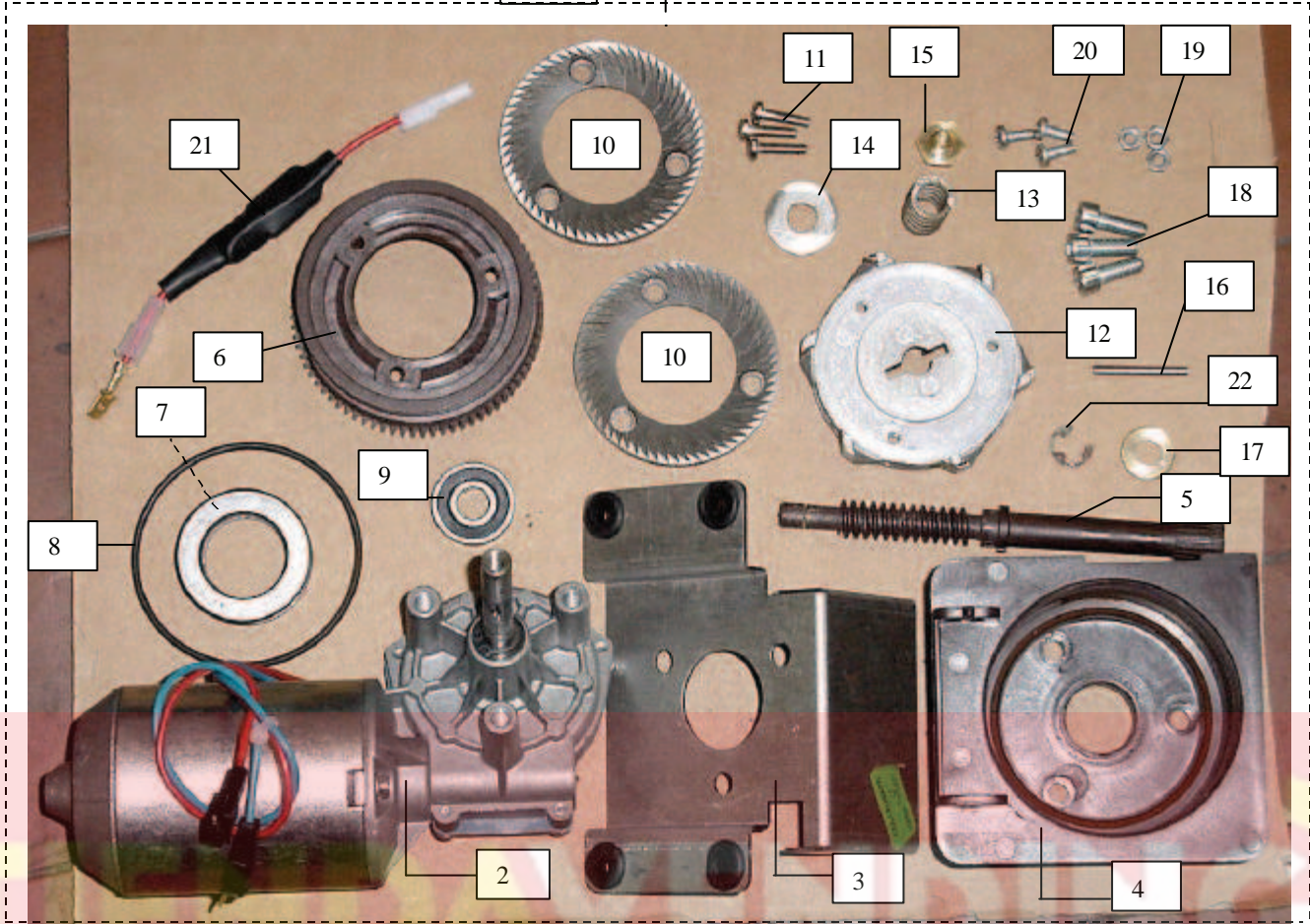

POSITION	CODE	DESCRIPTION	ITL PRICE
1	96044510	Doser grindeer assembly	333.350
2	20019016	24 V D.C. grinder motor	97.200
3	01586911	Grinder support	7.900
4	05134515	Grinder chamber	19.800
5	05134715	Adjustment knob	1.730
6	05134615	Ferrule	9.400
7	19059216	Ø25 42SP 11C 5110	#
8	36211316	OR 3262 NBR 70 Sh	250
9	19059116	Ø25 26SP 8 C 6000	#
10	18007316	Ø 64 Grinder	14.350
11	32060816	M 4 X16 Sself-screw/Not available	#
12	13008211	Grinder support	16.950
13	07020411	Grinder spring	850
14	01586411	Grinder support disc	500
15	19059011	Screw grindeer spring	3.100
16	12017411	Ø 3 x 1 30 pin	#
17	35155526	Ø 8,4 washer/Not available	#
18	32135516	TCE M6x16screw /Not available	#
19	34102816	4MA Exagonal nut/Not available	#
20	32060516	TCE M4x10 screw/Not available	#
21	22126612	Amperometric protector	10.450
22	37001116	Ø 7-9 seger/Not available	#



*Restyling models information and updates*

**TIENDA VENDING**



Restyling models information and updates

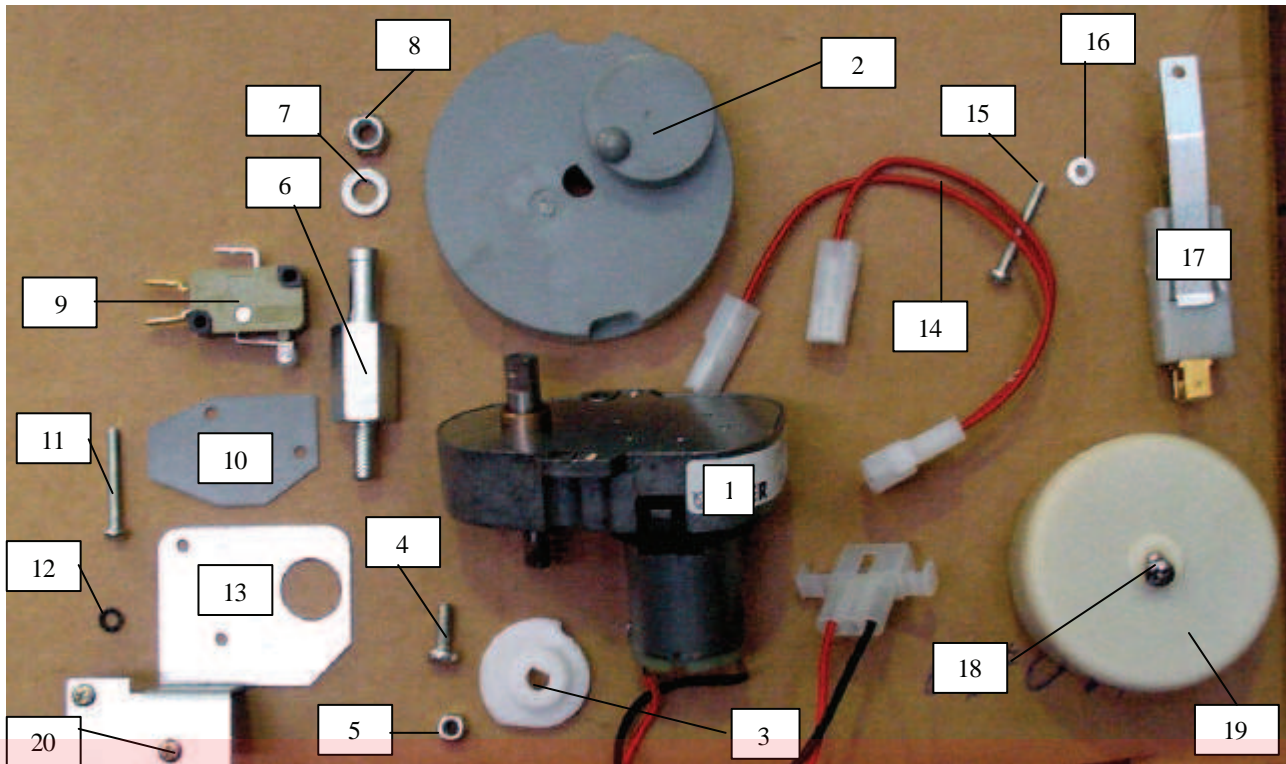

POSITION	CODE	DESCRIPTION	ITL PRICE
1	20018816	24 V D.C. gear motor	52.200
2	05089715	Nozzle drive cam	3.200
3	05110715	Microswitch cam	750
4	32060616	TC 4MAx12 screw/Not available	#
5	34110216	4MA self locking nut/ Not available	#
6	19057311	ANTARES drive pin	1.950
7	35155316	Ø 6,3 washer/Not available	#
8	34110416	6 MA self locking nut/Not available	#
9	26005126	XGM281 S 20 Microswitch	6.250
10	08004111	Microswitch insulation	300
11	32025816	3MAX18 screw/Not available	#
12	35160216	Ø 3,2 washer/Not available	#
13	01460811/01	Micro support plate/Not available	#
14	22111312	Low voltage cable	2.200
15	32026016	TC 3MAx25 screw/Not available	#
16	35155116	Ø 3,2 washer/Not available	#
17	26013716	Over-flow microswitch	5.250
18	32222866	3,9x 9,5 IX screw/Not available	#
19	05074412	Float assembly	2.950
20	32025516	TC 3MAx10 screw/Not available	#



Restyling models information and updates

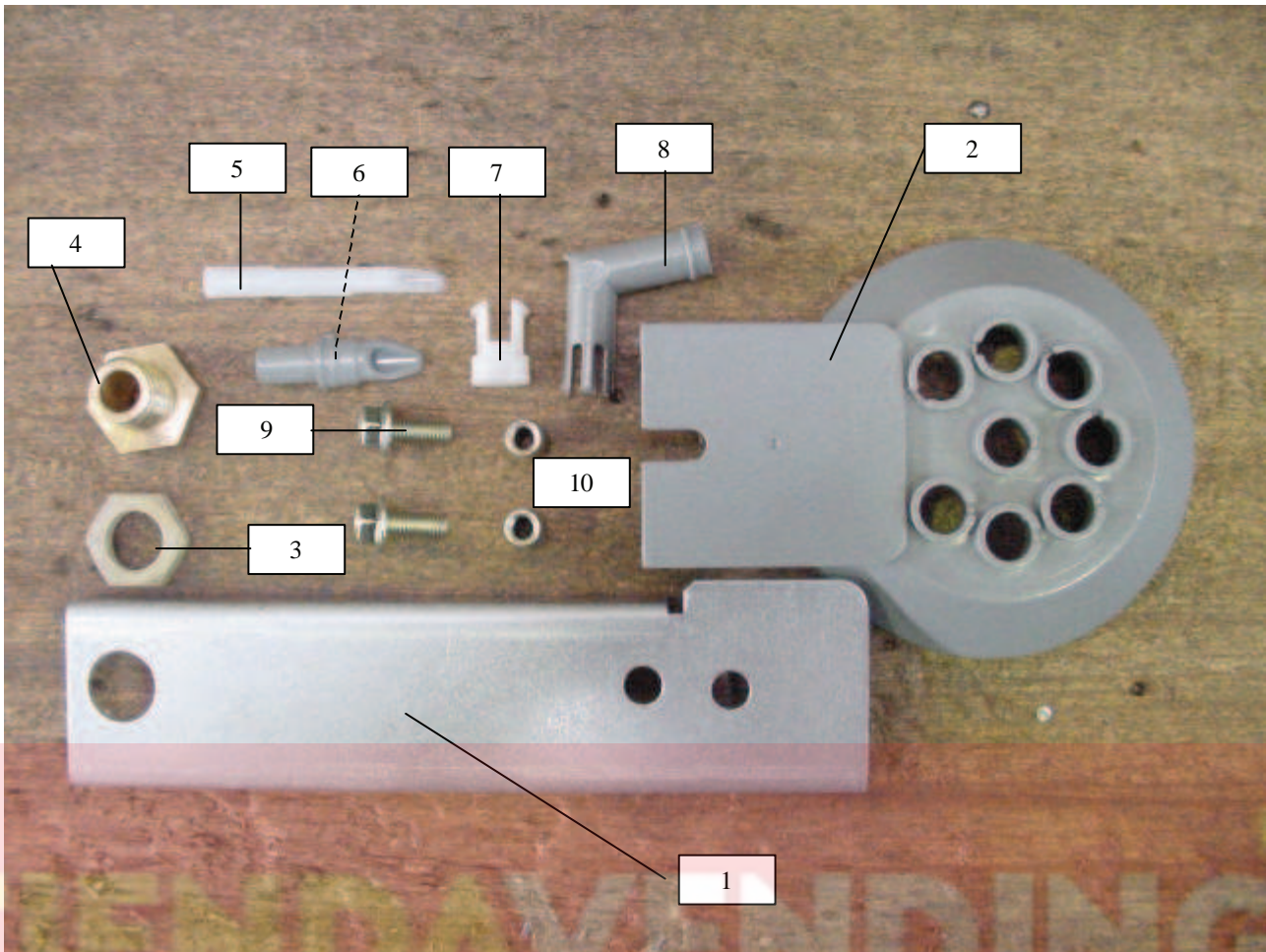

POSITION	CODE	DESCRIPTION	ITL PRICE
1	01509811	Dispensing support nozzles/ Not available	#
2	05089925	Nozzles support flange	3.300
3	04014111	¼" gas exagonal nut	650
4	19057411	Nozzle arm collet	1.650
5	05099715-01	Express bevelled straight dispensing	1.390
6	05096025	Bevelled straight dispensing nozzle	650
7	05099615	Capillary nozzle collet	1.050
8	05089815	Elbow dispensing nozzle	1.100
9	32122916	TE 5MAx10 screw/Not available	#
10	34112916	5 MA thread insert/Not available	
11			
12			
13			



*Restyling models information and updates*

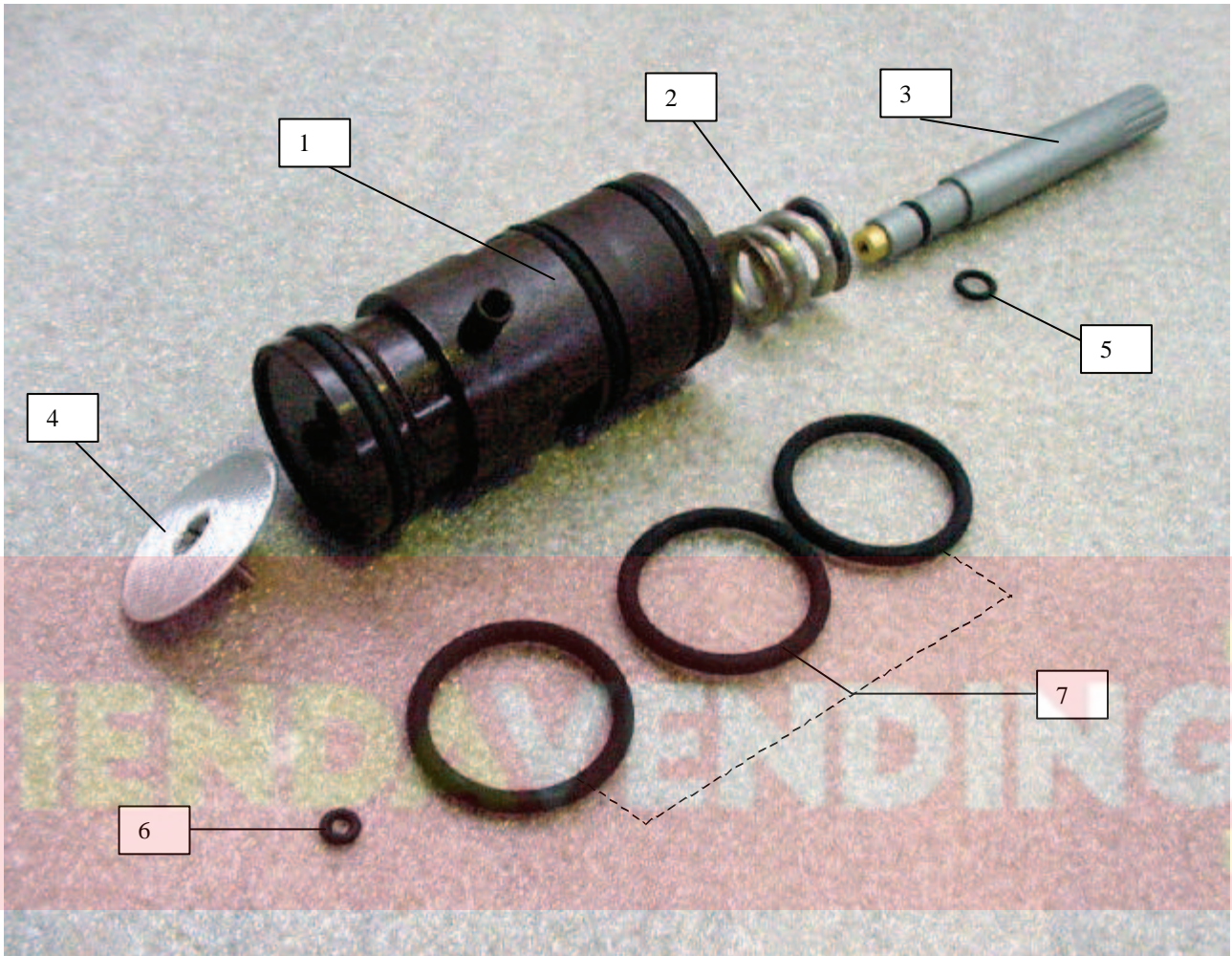

POSITION	CODE	DESCRIPTION	ITL PRICE
1	05148012	Group Bianchi piston	6.500
2	07017611	Spring piston	950
3	05107715-01	Knob	3.600
4	16014812	Coffe filter assembly	7.200
5	36210916	OR 2021 gasket	300
6	36212116	OR 2010 gasket	100
7	36211816	OR 4112 gasket	1.070

*Restyling models information and updates*

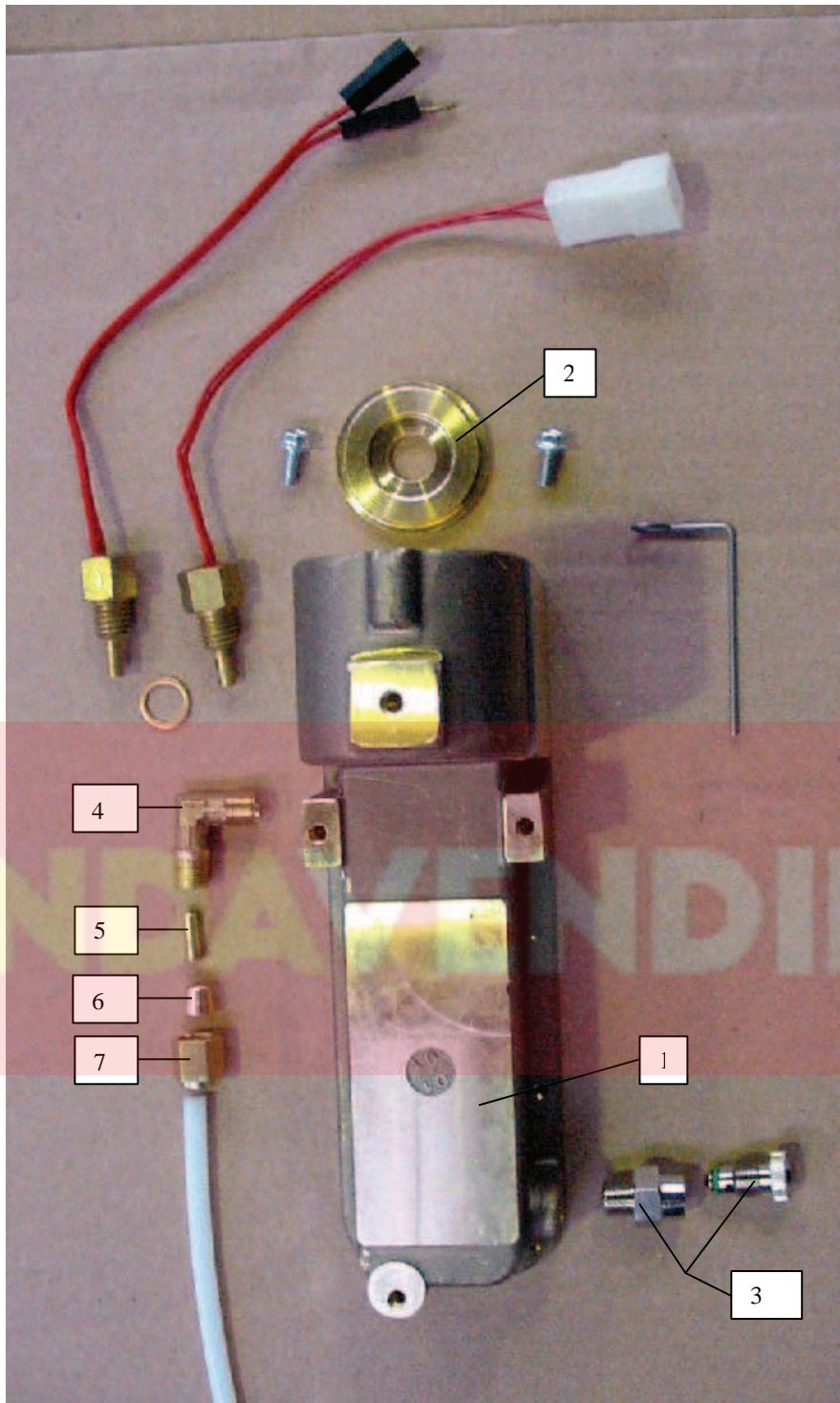

POSITION	CODE	DESCRIPTION	ITL PRICE
1	13007411-02	Coffe boiler body	124.200
2	18007011	Piston stop washer OT 58	3.600
3	04040316	OR 1/8" gas drain valve	2.700
4	04035326	1/8" elbow connection	3.700
5	19004326	Reinforcing bush	500
6	19046526	Anchirung bush	400
7	04035626	Locking nut	1.100



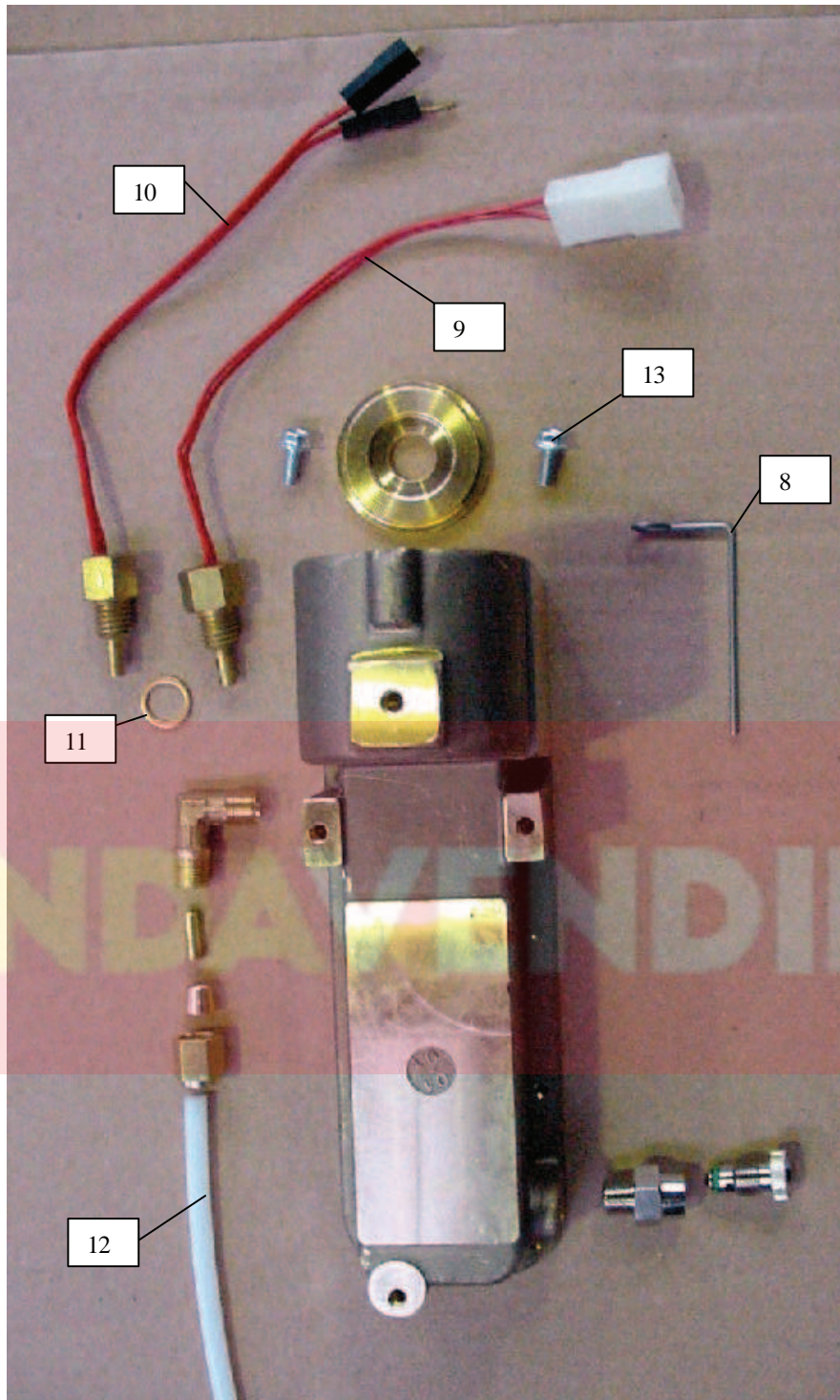

POSITION	CODE	DESCRIPTION	ITL PRICE
8	07017511	Security locking piston	550
9	26023712	Immersion probe	25.000
10	26023616	Immersion probe Pegaso only	25.000
11	18002516	Ø 10 copper gasket	200
12	09085423	4x6 teflon tube	9.000
13	32050516	TE M4x10 screw/Not available	#



*Restyling models information and updates*

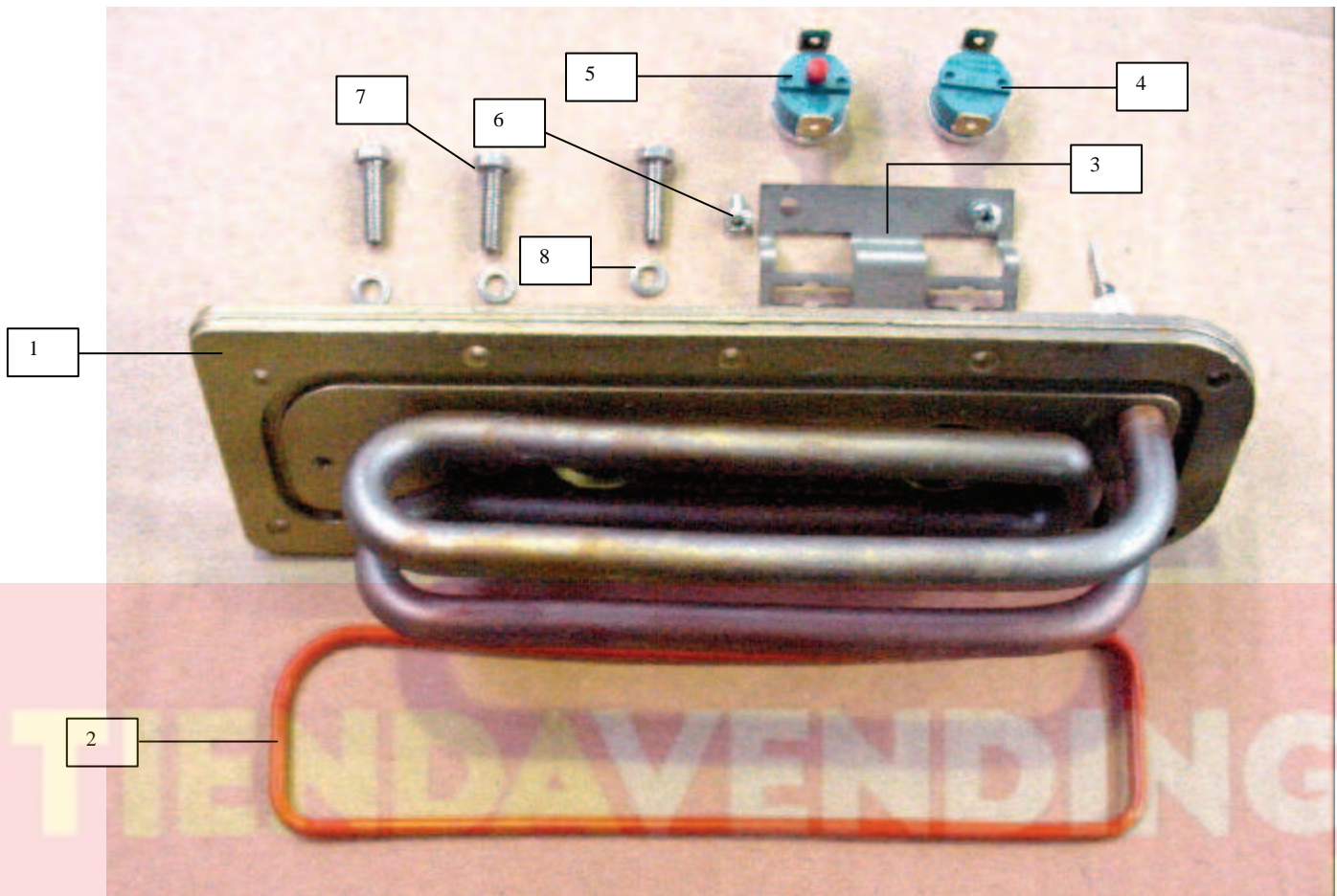

POSITION	CODE	DESCRIPTION	ITL PRICE
1	29004312	1500 W flange resistance assembly	52.000
2	05143815	Flange boiler gasket	1.000
3	01599411	Clixon stirrup	1.900
4	25020516	Autom clixon TY60R 135 C°	5.400
5	2502016	Manual clixon TY60R 110C°	5.950
6	/	NOT AVAILABLE	
7	32055536	TCEI 4MAX16screw/Not available	#
8	35153426	Washer/Not available	#
9			
10			

Restyling models information and updates

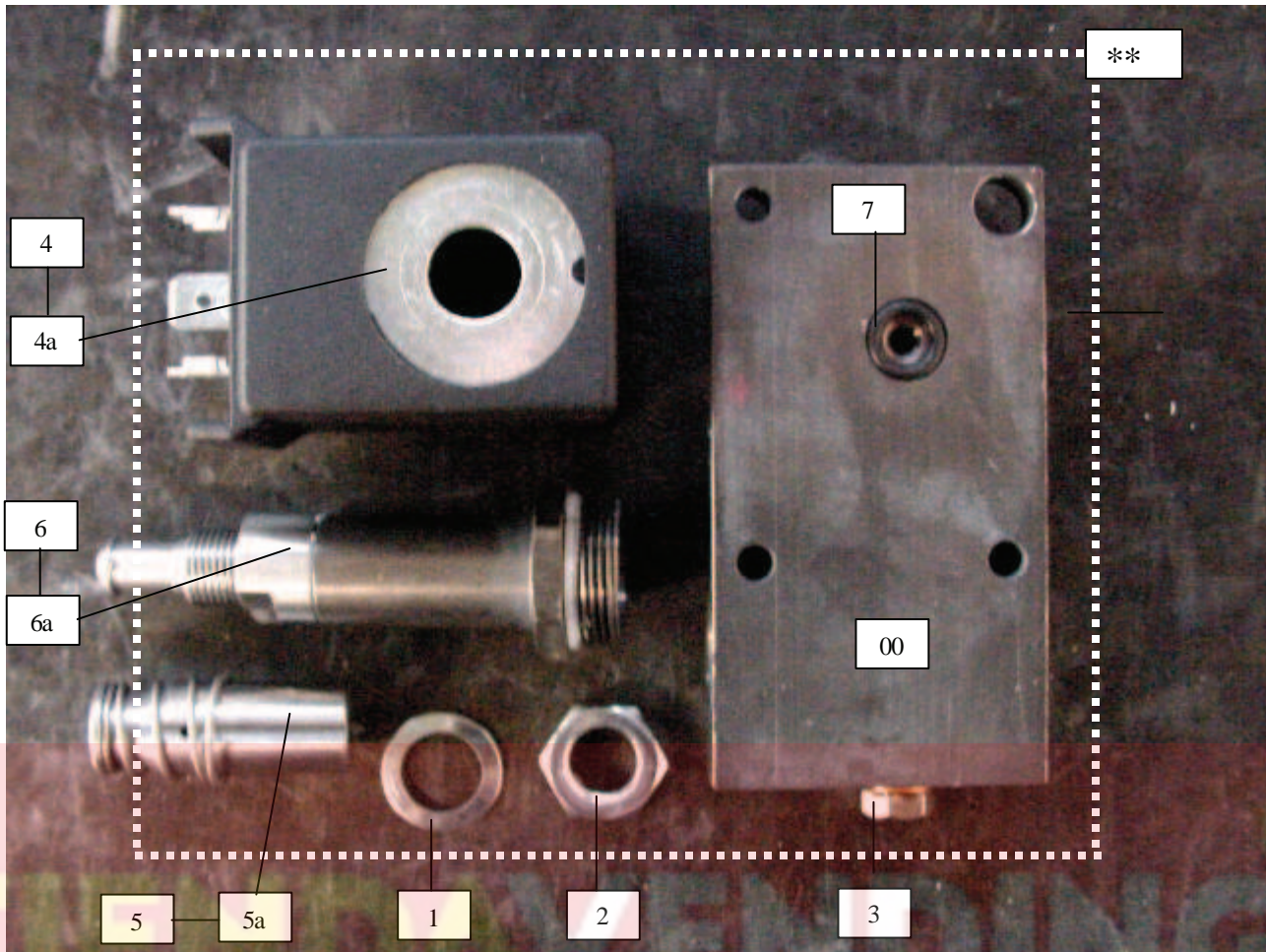

POSITION	CODE	DESCRIPTION	ITL PRICE
**	25018146-01	24 V D.C. three ways electrovalve	75.000
**	25018116-01	24 V A.C. three ways electrovalve	78.000
00	/	NOT AVAILABLE	#
1	/	NOT AVAILABLE	#
2	/	NOT AVAILABLE	#
3	/	NOT AVAILABLE	#
4	41037116	24 V D.C. OLAB TYPE solenoid	20.500
4	41037126	24 V A.C.OLAB TYPE solenoid	20.500
5	41037416	Armature tube OLAB TYPE	27.500
6	41037516	Plunger OLAB TYPE	15.500
4a	41037136	24 V D.C. 8W ODE TYPE solenoid	21.500
4a	41037146	24 V A.C. 8W ODE TYPE solenoid	21.500
5a	41037426	Plunger ODE TYPE	16.300
6a	41037526	Armature tube ODE TYPE	30.600
7	/	OR equipped position **	



Restyling models information and updates

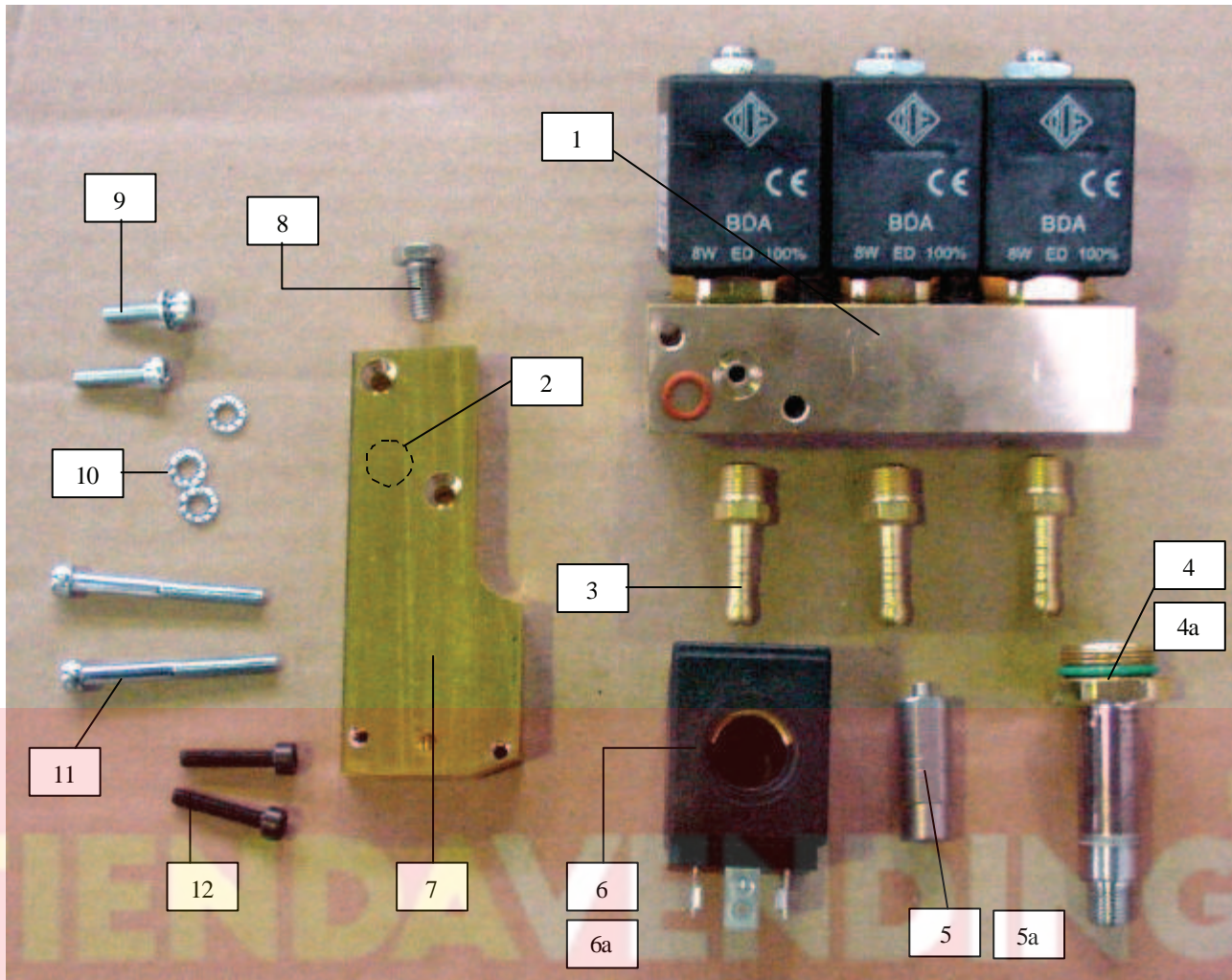

POSITION	CODE	DESCRIPTION	ITL PRICE
1	25019426	24 V A.C. 2ways 3 electrovalve group	147.000
1	25019416	24 V D.C. 2ways 3 electrovalve group	154.000
2	36350116	OR 2025 gasket	1.050
3	04032446	1/8" rubber holder coupling	2.200
4	41037316	Plunger OLAB TYPE	20.500
5	41037216	Armature tube OLAB TYPE	11.500
6	41037126	24 V A.C. OLAB TYPE solenoid	20.800
6	41037116	24 V D.C. OLAB TYPE solenoid	20.800
4a	41037326	Plunger ODE TYPE	21.500
5a	41037226	Armature tube ODE TYPE	12.900
6a	41037146	24 V A.C. ODE TYPE solenoid	21.500
6a	41037136	24 V D.C. ODE TYPE solenoid	21.500
7	19059411	Electrovalve support	34.200
8	32125336	TE 6MAX12 screw/not available	#
9	32065616	TCEI 4MAX16 screw/not available	#
10	35160316	Ø 4.2 WASHER /not available	#
11	32068416	TCEI 4MAX40 screw/not available	#
12	32067916	TCEI 4MAX20 screw/not available	#



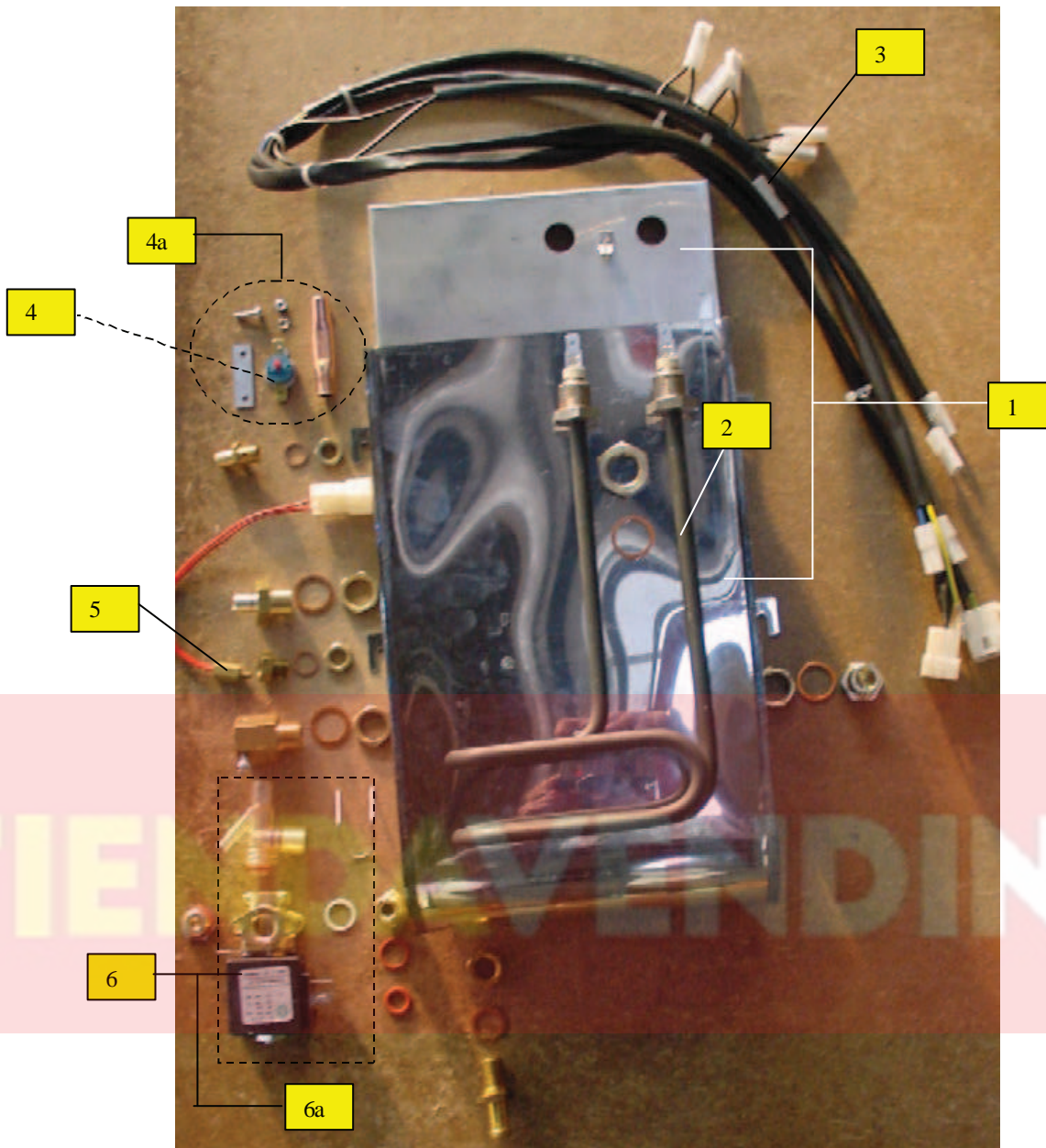

POSITION	CODE	DESCRIPTION	ITL PRICE
1	01587612	Boiler assembly box and lid	77.800
2	29003912-01	1300 W 230 V resistance	43.300
3	22112112-01	24/220 V boiler cable	30.000
4	25014936	Manual clixon TY 60 R C° 75	6.800
4a	25019610	Clixon assembly C° 75	9.400
5	26020612	Sensor N.T.C.	16.500
6	25017216	24 V. D.C. ODE TYPE *	50.100
6a	25017616	24 V. A.C. ODE TYPE **	50.100

\* 6 ANTARES/PEGASO (simple electrovalve)

\*\* 6a ORION/SIRIO (simple electrovalve)

*Restyling models information and updates*

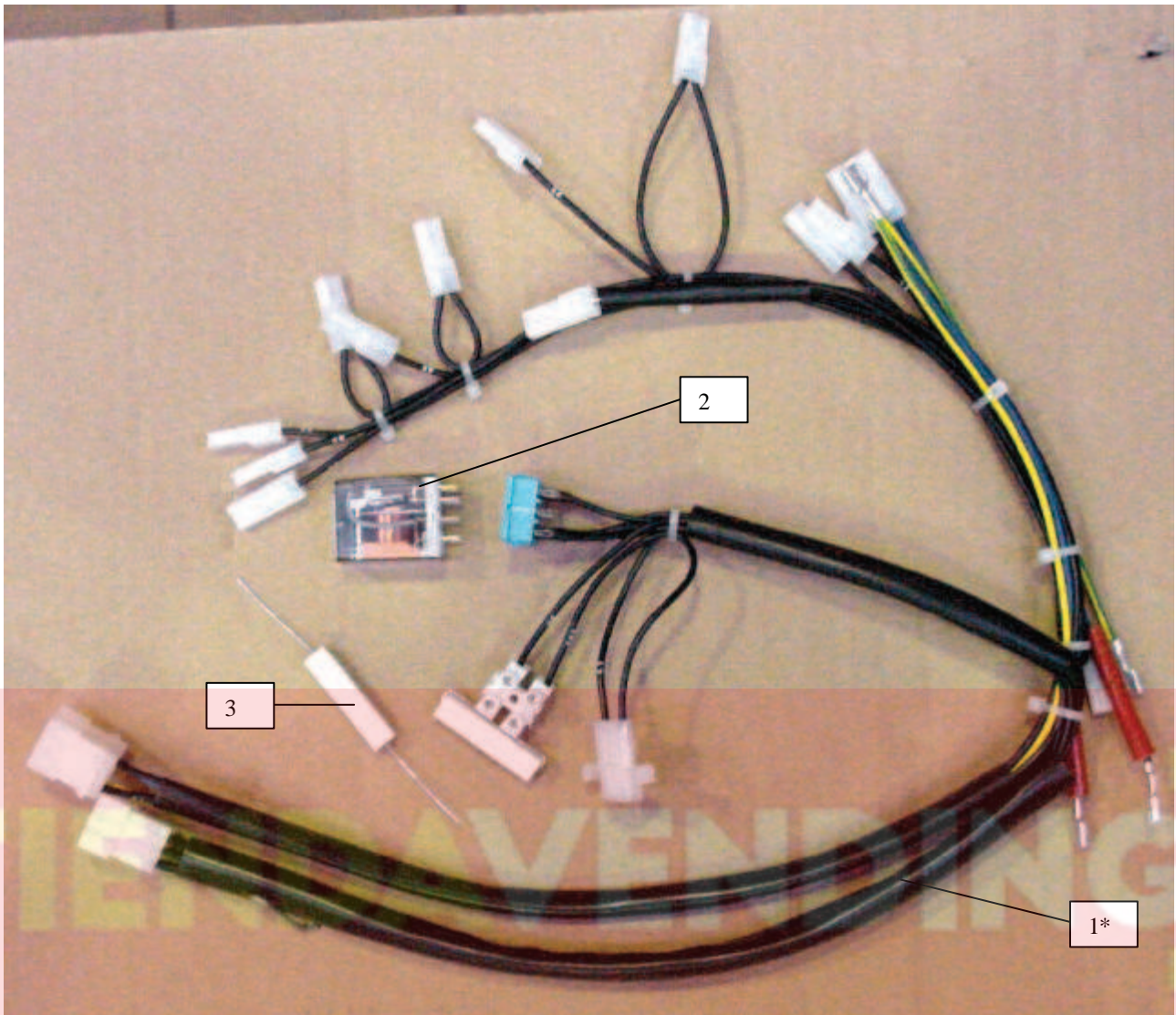

POSITION	CODE	DESCRIPTION	ITL PRICE
1* Antares	22117012-01	GB 230 V group cable	31.700
1* Pegaso	22115412-01	GB 230 V group cable	32.400
1* Orion/Sirio	22119812	GB 230 V group cable/mono boiler	31.700
1* Orion/Sirio	22106612	GB 230 V group cable/double boiler	31.700
2	26017356	24 V D.C. single conctat relay	15.000
3	26015946	9W – 10 Ohm resistance	1.350



Restyling models information and updates

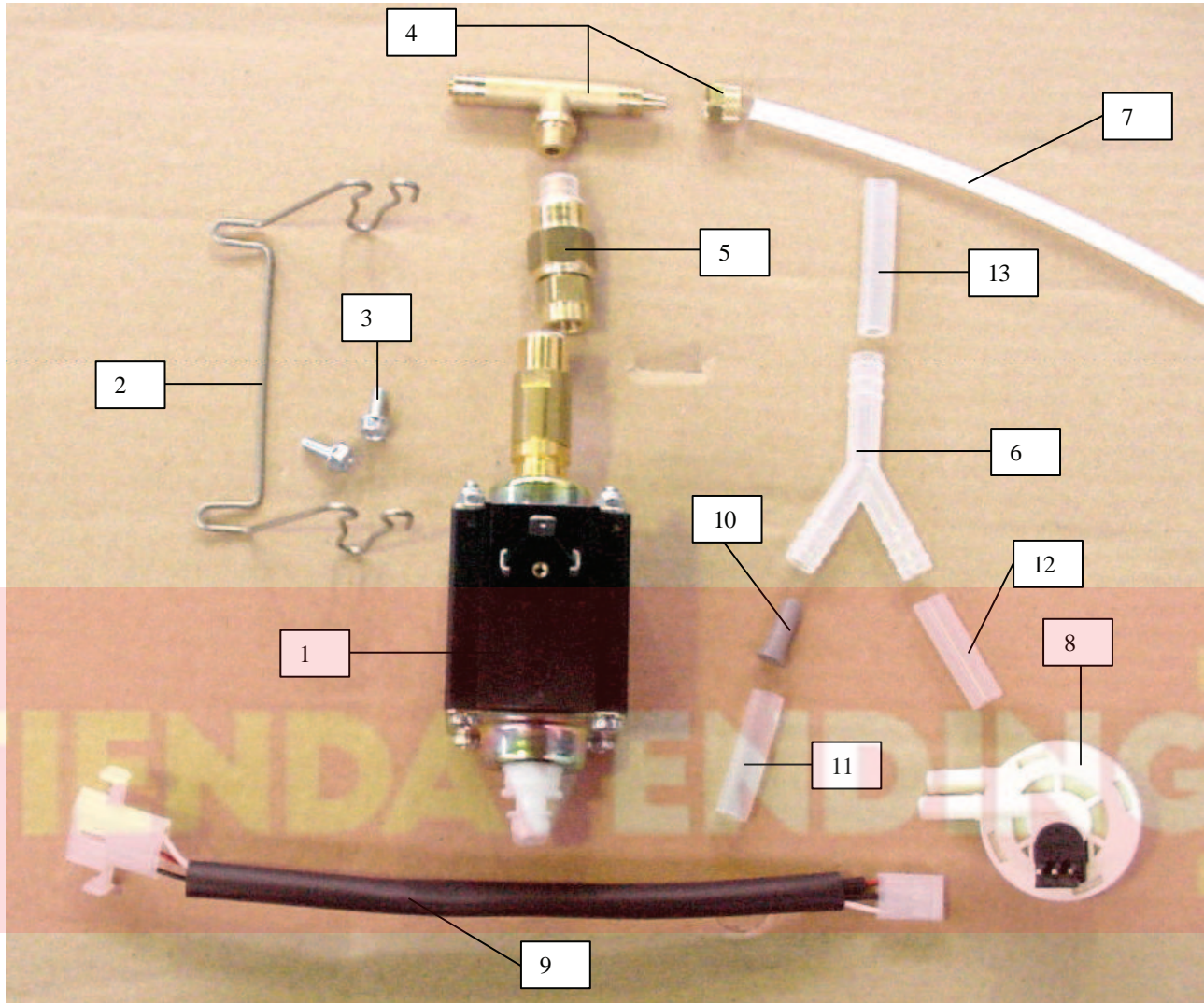

POSITION	CODE	DESCRIPTION	ITL PRICE
1	27002816	230 V 50hz electric pump	70.900
2	07016416	Pump support	3.500
3	32050516	TE M4x10 screw/Not available	#
4	04040916	Safety valve 11 Bar	11.000
5	04041016	Check valve Maschio	8.900
6	05033716	Three ways connector ART 467	1.750
7	09085423	4x6 L=200 tube teflon	9.000
8	24012116	Flow sensor	18.000
9	22083632-01	Fan cable L=220	6.700
10	05102215	Adapter	400
11	To see attached document		
12	To see attached document		
13	To see attached document		



## Tubes : spare parts codes

CODE	DESCRIPTION	ITL PRICE
090877921	7x11 silicon tube mt 1	6.900
09089513	P.V.C. tube mt 1	9.450
09089713	Santoprene tube 5x8 mt 1	4.800
09085423	Teflon tube 4x6 mt 1	9.000
09085413	Teflon tube 4x2 mt 1	7.700
09053211	Akulon tube 4x6 mt 1	2.300
09040021	Silicon tube 8x12 mt 1	6.150
09027623	Cristal P.V.C. tube 12x16 mt 1	3.150
09027643	Cristal P.V.C. tube 14x17 mt 1	5.100
09031113	Levinflex tube 28x33 mt 1	7.250
09031133	Levinflex tube 40x46 mt 1	9.450
09037141	Silicon tube 4x6 mt 1	3.500
09038361	Silicon tube 6x9 mt 1	5.150
09039311	Silicon tube 8x11 mt 1	5.800
09065941	Silicon tube 8x7 mt 0,8	1.200

*Restyling models information and updates*

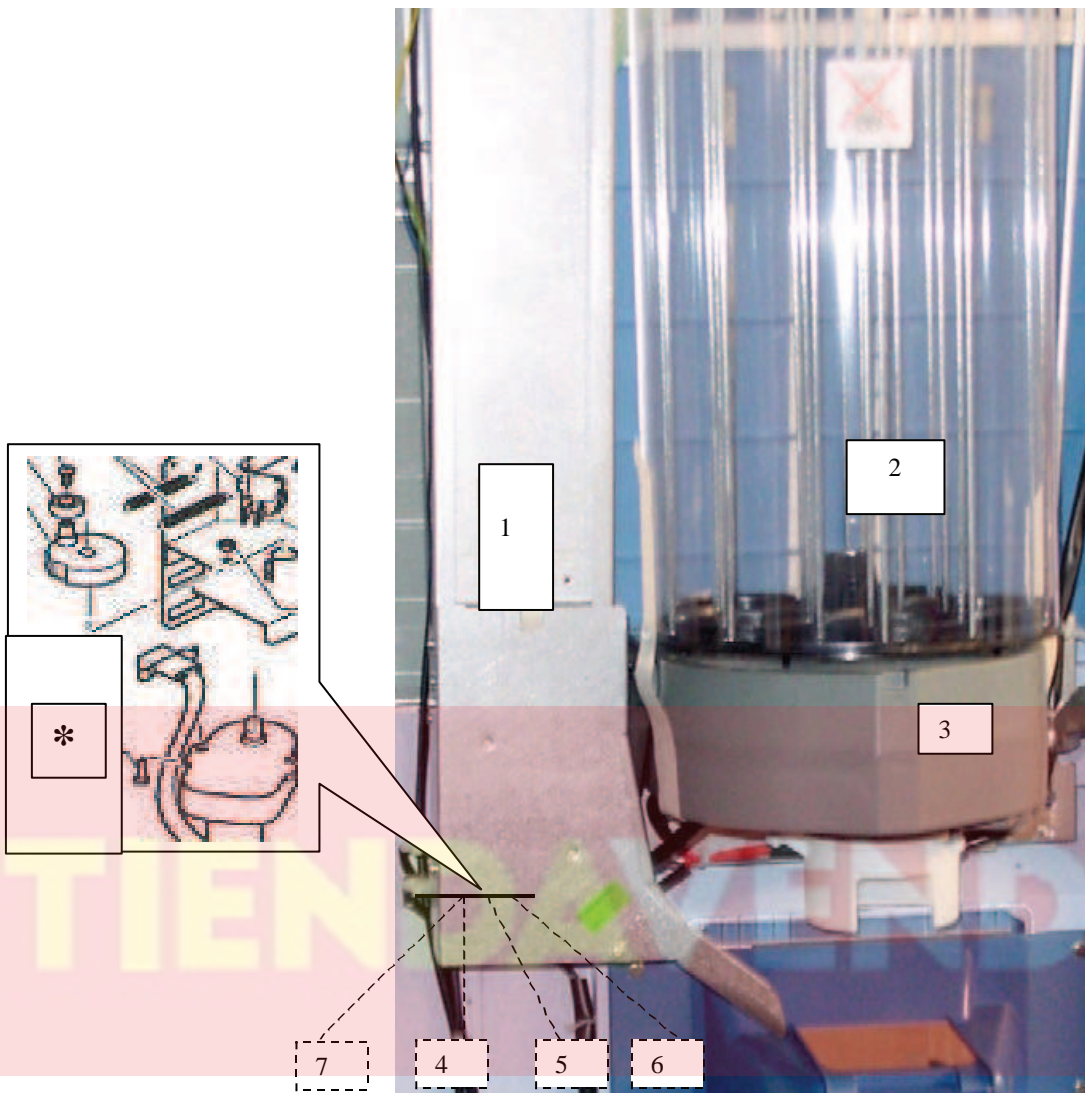

POSITION	CODE	DESCRIPTION	ITL PRICE
1	91002710	Spoon dispenser assembly	104.400
2	28007316	Cups turret (500 units)	96.700
3	28005516	24 V D.C.cup dispenser assembly	276.000
4*	20022016	24 V D.C. gearmotor	44.500
5*	05104015	Microswitch cam	950
6*	05104915	Spoon cam wheel	100
7*	26005126	XGM 281 S 20 microswitch	3.700
8			
9			
10			
11			

*Restyling models information and updates*

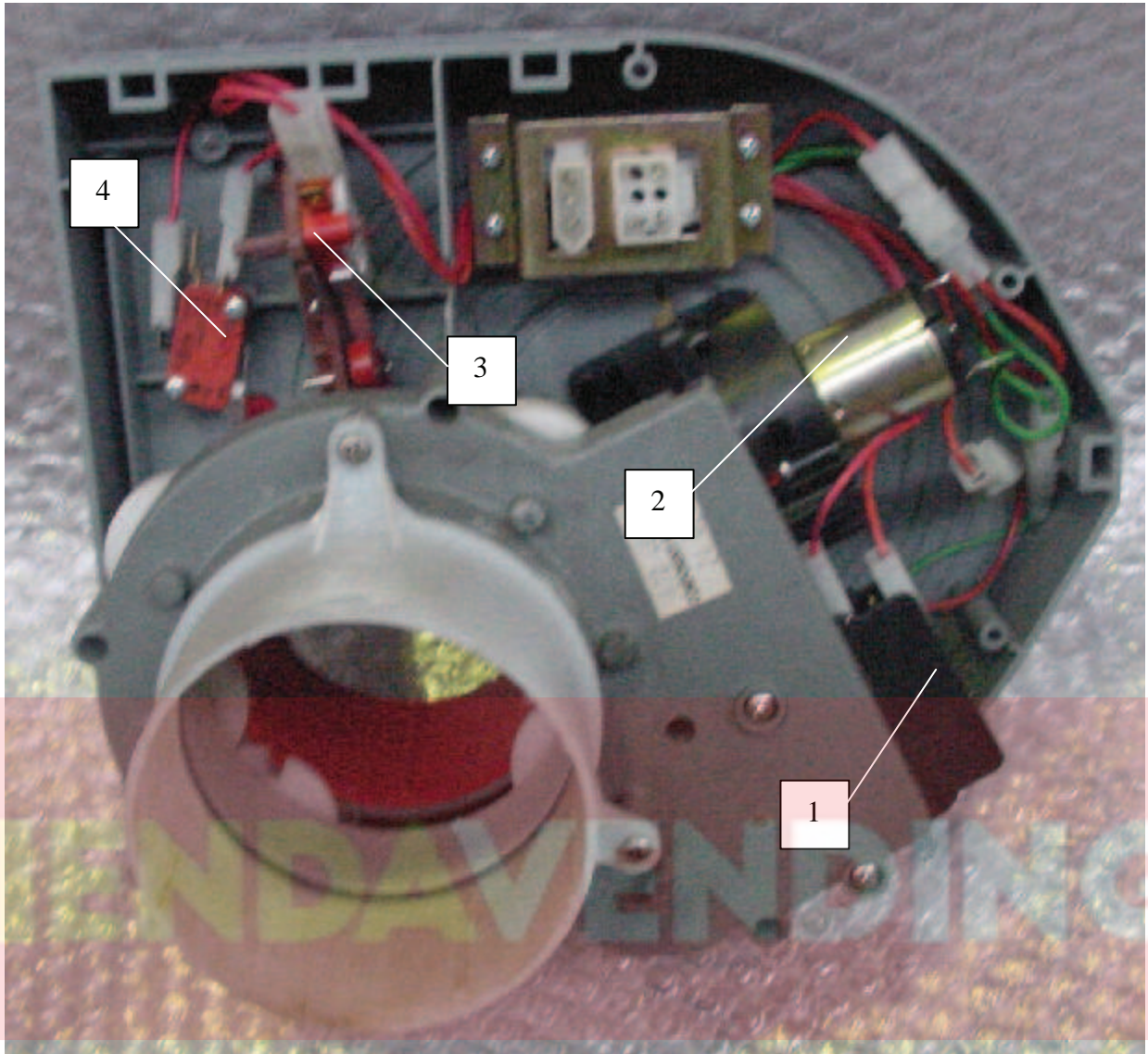

POSITION	CODE	DESCRIPTION	ITL PRICE
1	41026816	24 V D.C.distribution cup motor	61.000
2	41005216	24 V D.C. turret cup motor	66.250
3	41037816	Cups dispenser microswitch	9.000
4	41037916	Cups movement microswitch	9.000
5			
6			
7			
8			
9			
10			
11			



*Restyling models information and updates*

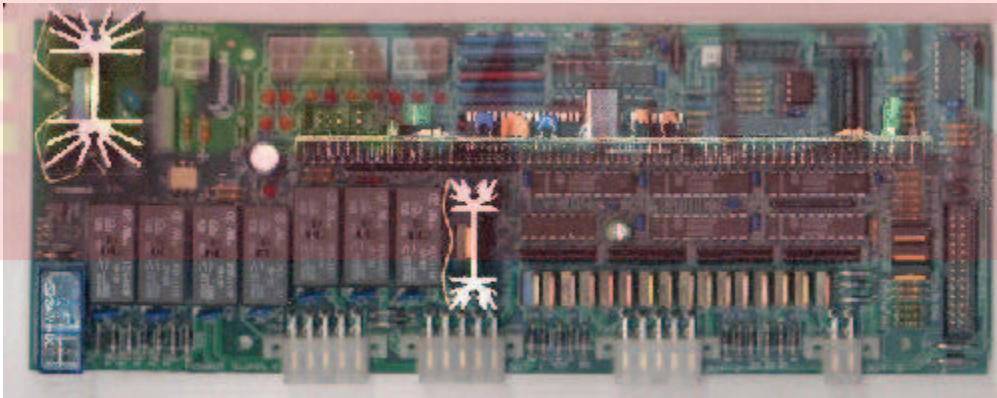

POSITION	CODE	DESCRIPTION	ITL PRICE
1	26027112	Antares /Pegaso /Sirio display	54.000
2	26027316	Antares/Pegaso/Sirio master board	283.000
3	26027216	Antares/Pegaso/Sirio power board	448.000
4	22125012	Connection cable	9.000

Restyling models information and updates

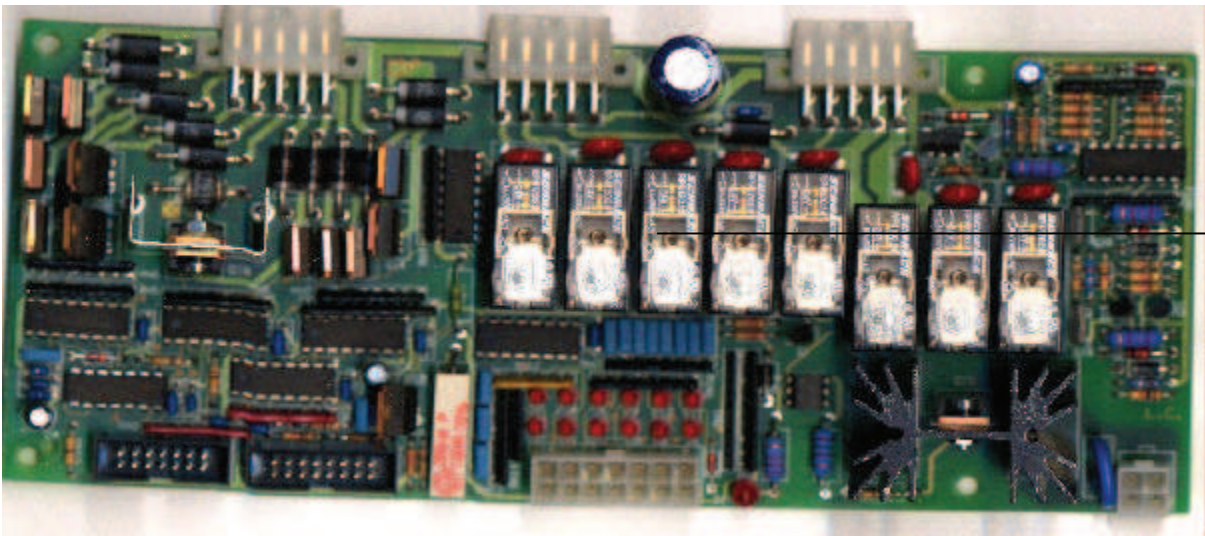

1

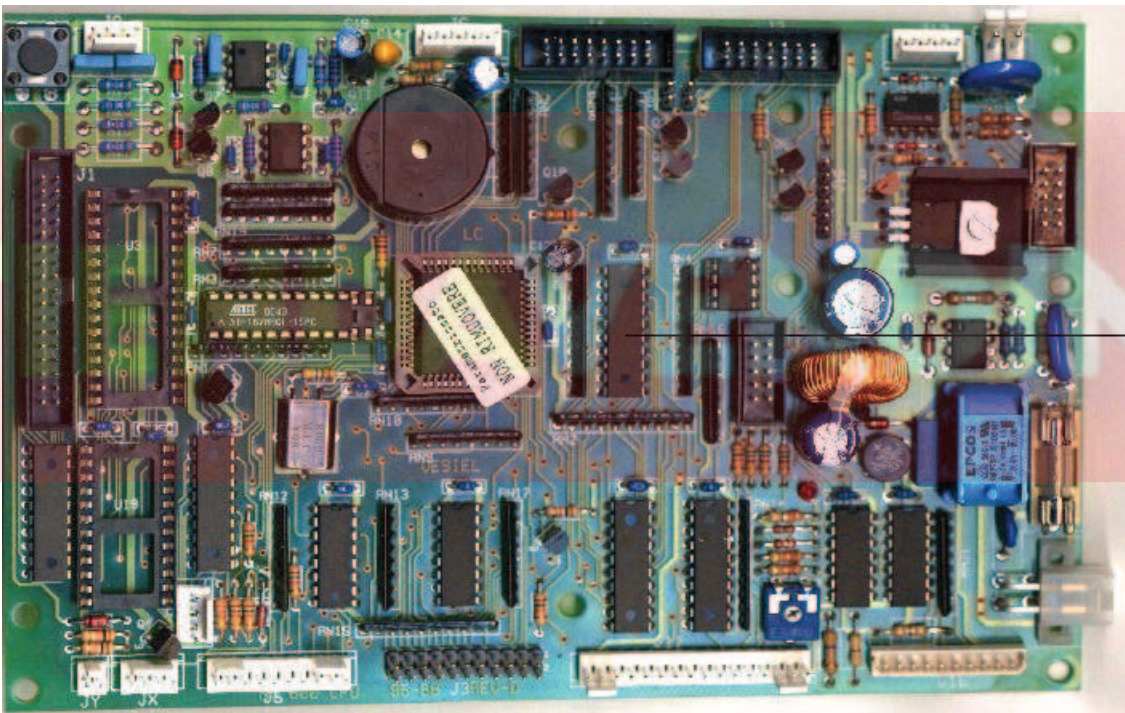

2

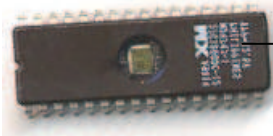

3

POSITION	CODE	DESCRIPTION	ITL PRICE
1	26024116-02	POWER BOARD	349.200
2	26019746-01	C.P.U. BOARD	331.200
3	41026616	EPROM 1 Mbit	43.000



Restyling models information and updates

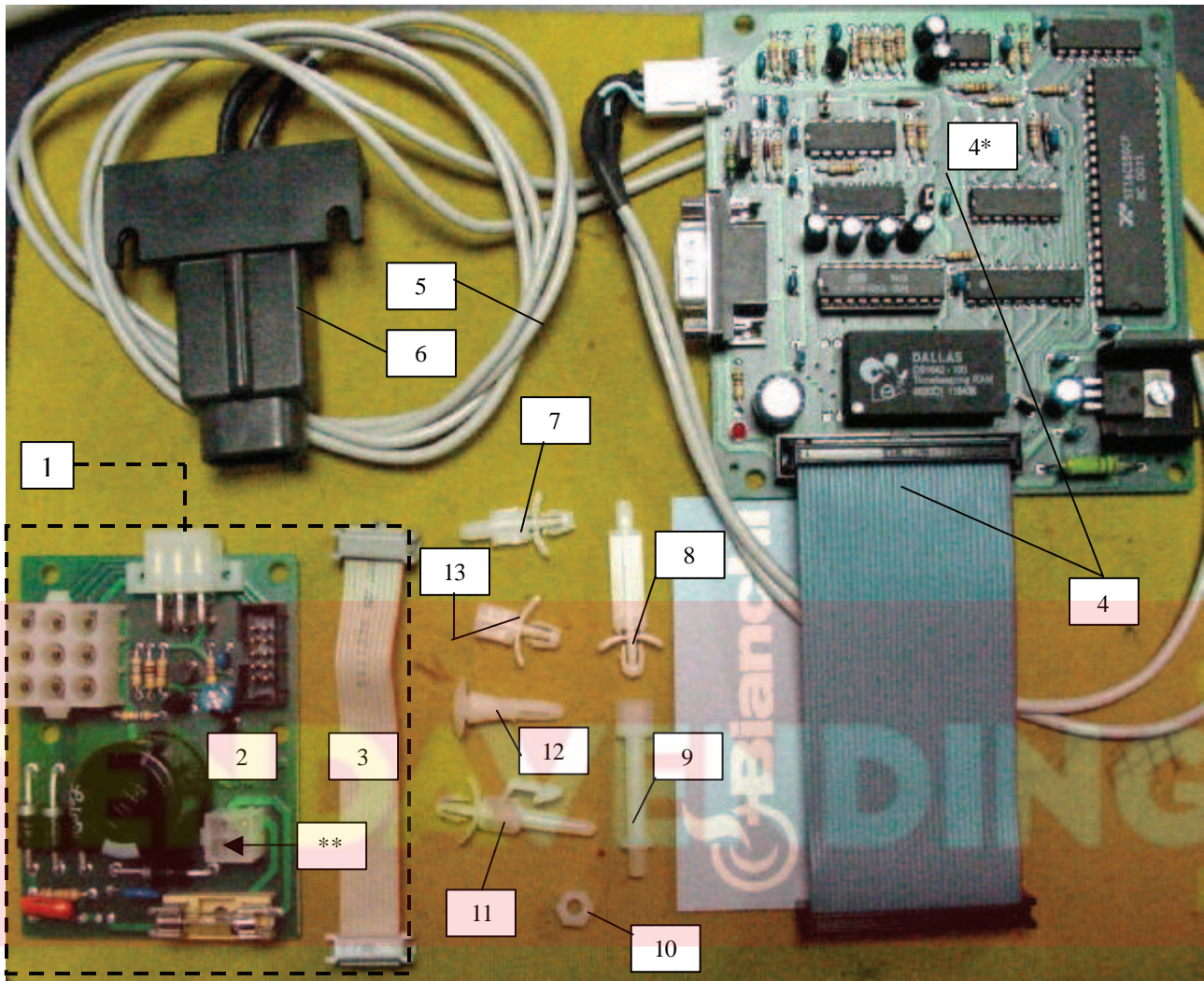

POSITION	CODE	DESCRIPTION	ITL PRICE
1	26021820	MDB BDV kit	88.800
2	26021116	Expansion board mdb/bdv	74.800
3	22097712	Flat cable	5.400
4	26027020	Clock/audit kit	330.000
4*	26021016	Expansion board clock/audit	270.000
5	2210 9812	Rubber coated cable	15.700
6	89013826	Infrared sensor	42.800
7	33065526	Spacing collar board	400
8	33065566	Spacing collar board	300
9	33065616	Spacing collar board	300
10	33065726	4 M A hexagonal nut	300
11	33065016	Spacing collar board	500
12	33066316	Spacing collar board	500
13	33065116	Spacing collar board	500
**	22097622	Power cable	7.800